



Barbara Brackman

CIVIL WAR JUBILEE

1850–1870

Celebrating the
150th Anniversary of the
Emancipation Proclamation

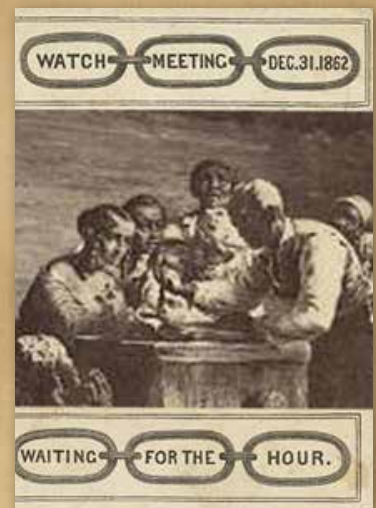

Size: 76" x 88"

moda

moda
CIVIL WAR JUBILEE
 Barbara Brackman
 76"x88"

*Read instructions before beginning a project.
 All instructions include a 1/4" seam allowance.
 Press as you go. Press seams in one direction.
 WOF = Width of Fabric*

Cutting

*For ease of piecing sort and label all pieces as they are cut.
 Fabrics 1-4 are "lights" and Fabrics 5-15 are "darks"
 There will be a few extra pieces depending on the fabric combinations that you choose.*

Fabric 1

Cut 8-2 1/2"xWOF strips
 From each of 7 strips subcut 2-2 1/2"x 12 1/2" strips,
 2-2 1/2"x 4 1/2" strips and 3-2 1/2"x 2 1/2" squares
 From the 8th strip subcut 13-2 1/2"x 2 1/2" squares
 Cut 2-4 1/2"xWOF strips
 Subcut 7-4 1/2"x 8 1/2" rectangles for centers and
 1-3"x 3" square for inner border corner square

Fabric 2

Cut 4-2 1/2"xWOF strips
 From each of 3 strips subcut 2-2 1/2"x 12 1/2" strips,
 2-2 1/2"x 4 1/2" strips and 3-2 1/2"x 2 1/2" squares
 From the 4th strip subcut 12-2 1/2"x 2 1/2" squares
 Cut 1-4 1/2"xWOF strip Subcut 3-4 1/2"x 8 1/2" rectangles
 for centers and 1-3"x 3" square for inner border corner

Fabrics 3 & 4

From **each** fabric
 Cut 7-2 1/2"xWOF strips
 From each of 6 strips subcut 2-2 1/2"x 12 1/2" strips,
 2-2 1/2"x 4 1/2" strips and 3-2 1/2"x 2 1/2" squares
 From the 7th strip subcut 15-2 1/2"x 2 1/2" squares
 Cut 2-4 1/2"xWOF strips
 Subcut 7-4 1/2"x 8 1/2" rectangles for centers

Fabrics 5-15

From **each** fabric
 Cut 2-2 1/2"xWOF strips
 Subcut 2-2 1/2"x 12 1/2" strips, 2-2 1/2"x 4 1/2" strips and
 3-2 1/2"x 2 1/2" squares
 Cut 1-4 1/2"xWOF strips
 Subcut 2-4 1/2"x 8 1/2" rectangles for centers and
 6-2 1/2" squares

Choose your favorite dark fabric to cut pieces for one additional Block B. From the remainder of this fabric cut:

Cut 1-2 1/2"xWOF strip
 Subcut 2-2 1/2"x 12 1/2" strips, 2-2 1/2"x 4 1/2" strips and
 4-2 1/2"x 2 1/2" squares
 Cut 1-4 1/2"xWOF strip Subcut 1-4 1/2"x 8 1/2" rectangles
 for center

Fabric 16 – Inner Border and Binding

Cut 1-12 1/2"xWOF strip
 Subcut 10-12 1/2"x 2 1/2" strips and 6-8 1/2"x 2 1/2" strips
 Cut 1-8 1/2"xWOF strip
 Subcut 12-8 1/2"x 2 1/2" strips and 2-3"x 3" squares for
 border corner square
 Cut 9-2 1/2"xWOF strips for binding

Fabric 17 – Outer Border

Cut 8-6 1/2"xWOF strips

Block Construction

Marking: Using a mechanical pencil draw a diagonal line from corner to corner on the wrong side of all of the 2 1/2" squares

Sorting: To avoid confusion and mismatched blocks choose pieces for each block before beginning to sew. Each block requires 2- 2 1/2"x 12 1/2" and 2-2 1/2"x 4 1/2" matching strips for chains and 1-4 1/2"x 8 1/2" and 4-2 1/2"x 2 1/2" matching pieces for center and corners. *Note: There will be extra 2 1/2" squares. These will be used in the inner border.*

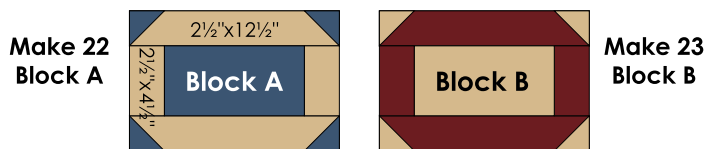

The following directions are for one block. Repeat steps below to make a total of 45 chain blocks – 22 Block A's with dark center and light chains and 23 Block B's with light centers and dark chains.

1. When block sorting is complete, align corners and edges of 2-2 1/2" squares on opposite ends of a 2 1/2"x 12 1/2" strip. *Note direction of marked line.* With right sides together stitch on line. Trim extra fabric 1/4" from seam line. Press triangle toward corner. Make 2.

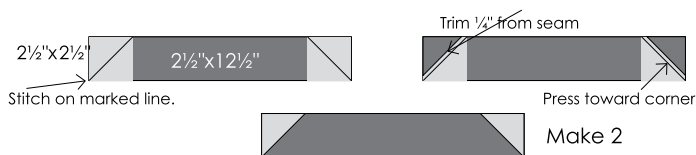

2. With right sides together stitch a 2 1/2"x 4 1/2" strip to opposite ends of 4 1/2"x 8 1/2" center rectangle. Press seams toward center. Unit should measure 4 1/2"x 12 1/2" with seams.

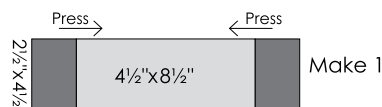

Block Construction - cont.

- Noting direction of triangles sew matching strips from Step 1 to top and bottom of center unit. Press dark chain blocks toward center. Press light chain blocks toward strips. Block should measure $12\frac{1}{2} \times 8\frac{1}{2}$ " with seams.

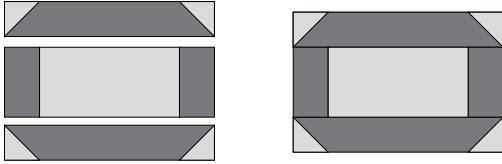

Repeat to make 22-Block A and 23-Block B

moda

Assemble Quilt

Note: For best results arrange all blocks on a design wall before assembling quilt top.

Piece 9 rows of 5 blocks:

Make 5 of Row 1 with 3 Block Bs and 2 Block As

Make 4 of Row 2 with 3 Block As and 2 Block Bs

Stitch rows together beginning and ending with a Row 1.
Press. **Quilt top should measure $60\frac{1}{2} \times 72\frac{1}{2}$ " with seams.**

Corner Squares – Fabric 16 2-3" squares and 1 each of Fabrics 1 & 2

Using a mechanical pencil draw a diagonal line from corner to corner on the wrong side of Fabrics 1 and 2. With right sides together align edges of Fabric 16 squares and each light square. Stitch $\frac{1}{4}$ " on opposite sides of marked line(s).

Cut on marked line. Press seams toward dark triangle.

Trim half square triangle units to measure $2\frac{1}{2} \times 2\frac{1}{2}$ ".

Yield 4 units.

Inner Border

- From remaining $2\frac{1}{2}$ " marked squares randomly select 32 dark (Fabrics 5-15) and 24 light (1-4) for inner border.
- Using the $10-2\frac{1}{2} \times 12\frac{1}{2}$ " inner border strips stitch a $2\frac{1}{2}$ " square on opposite ends of each strip. *Refer to Step 1 under Block Construction.* Make 6 with dark corners and 4 with light corners.
- Use the completed units from above to stitch 2 rows of 5. Each row should include 3 strips with dark corners and 2 with light. Press seams toward dark. Stitch to top and bottom of quilt top. Press.
- Repeat Step 2 using $18-2\frac{1}{2} \times 8\frac{1}{2}$ " inner border strips. Stitch 10 with dark corners and 8 with light corners.
- Use the completed units from Step 4 to stitch 2 rows of 9. Each row should include 5 with dark corners and 4 with light corners. Press seams toward light.
- Noting color placement (*Fabric 16 triangles should point toward outer border*) and add prepared corner squares to opposite ends of the 2 inner border strips. Press.
- Stitch inner border strips to opposite sides of quilt top. Press. **Quilt top should measure $64\frac{1}{2} \times 76\frac{1}{2}$ " with seams.**

Outer Border

- Using a diagonal seam join the 8 – $6\frac{1}{2} \times$ WOF outer border strips into pairs to make 4 long borders. Press seams open.
- Cut each border strip to measure $6\frac{1}{2} \times 76\frac{1}{2}$ ".
- Stitch a border strip to opposite sides of quilt top. Press toward outer border.
- Add remaining borders to top and bottom of quilt top. Press.
Quilt top should measure $76\frac{1}{2} \times 88\frac{1}{2}$ " with seams.

Finishing

Using a diagonal seam, join the 9 – $2\frac{1}{2} \times$ WOF strips end to end. Press seams open. Fold prepared strip in half wrong sides together and press to make the binding.

Layer, Quilt and Bind

Corner Square

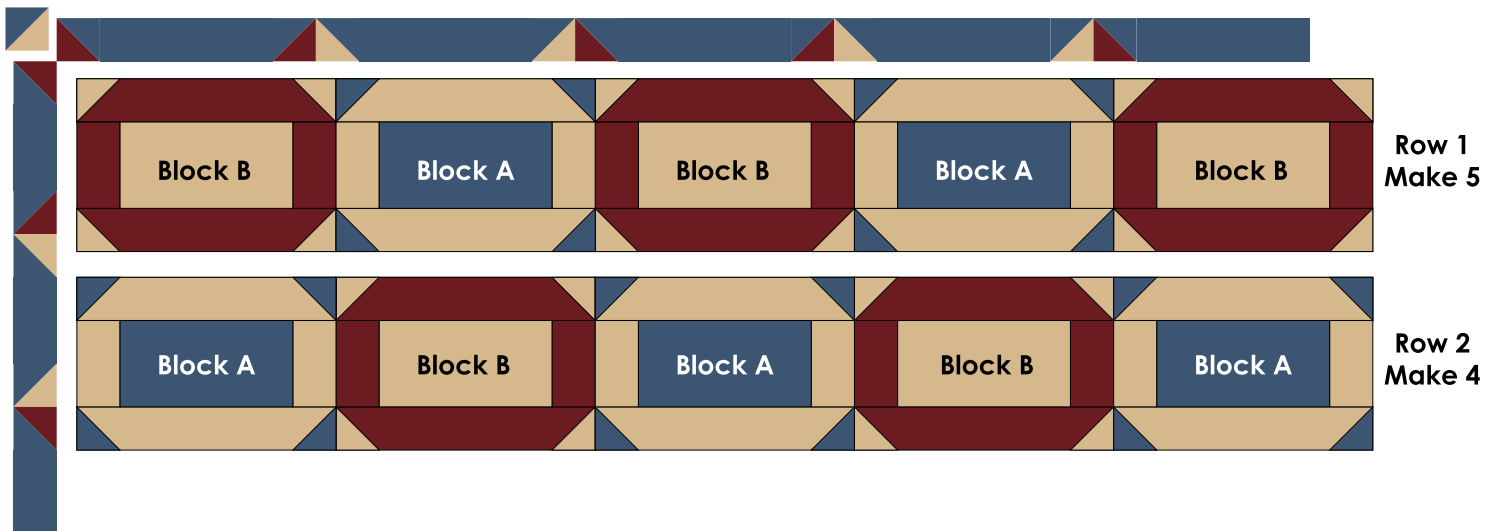

CIVIL WAR JUBILEE

Barbara Brackman

76"x88"

Fabric Requirements

FABRIC #1— $\frac{7}{8}$ yd

Blocks

46171-11



FABRIC #10— $\frac{1}{2}$ yd

Blocks

8256-11



FABRIC #2— $\frac{1}{2}$ yd

Blocks

46171-15



FABRIC #11— $\frac{1}{2}$ yd

Blocks

8256-12



FABRIC #3— $\frac{7}{8}$ yd

Blocks

8252-15



FABRIC #12— $\frac{1}{2}$ yd

Blocks

8256-13



FABRIC #4— $\frac{7}{8}$ yd

Blocks

8258-15



FABRIC #13— $\frac{1}{2}$ yd

Blocks

8256-14



FABRIC #5— $\frac{1}{2}$ yd

Blocks

8250-18



FABRIC #14— $\frac{1}{2}$ yd

Blocks

8258-11



FABRIC #6— $\frac{1}{2}$ yd

Blocks

8250-19



FABRIC #15— $\frac{1}{2}$ yd

Blocks

8258-12



FABRIC #7— $\frac{1}{2}$ yd

Blocks

8250-23



FABRIC #16— $1\frac{1}{2}$ yds

Inner Border &
Binding

8253-11



FABRIC #8— $\frac{1}{2}$ yd

Blocks

8254-13



FABRIC #17— $1\frac{5}{8}$ yds

Outer Border

8251-12



FABRIC #9— $\frac{1}{2}$ yd

Blocks

8254-14



BACKING — $5\frac{1}{4}$ yds



moda

MODAFABRICS.COM

PS8250 — SUGGESTED RETAIL \$6.00

Stay Connected

modafabrics.com

