



This block finishes at 6" or 12" square.

🎄 INGREDIENTS

6" Block

From white fabric, cut (1) 3-1/2" square, (4) 3" squares, (1) 2-1/2" square

From red fabric, cut (1) 3-1/2" square, (2) 3" squares

12" Block

From white fabric, cut (1) 5-1/2" square, (4) 5" squares, (1) 4-1/2" square

From red fabric, cut (1) 5-1/2" square, (2) 5" squares

🎄 INSTRUCTIONS

The method of making each size block is exactly the same. The only difference is the size of the pieces. All of the instructions below will list the 12" block pieces first, with the 6" block pieces in parenthesis.

Making the half square triangles:

Draw a diagonal line from corner to corner on the 5" (3") background squares (note: you will only use half of the 5" (3") background squares for this step, but go ahead and draw the line on all of them). Pair each square with a 5" (3") print square, right sides together. Sew 1/4" away from the line on both sides. Cut apart on the center lines and press towards the print fabric to create half square triangles (HST). You will have four HSTs of each print. Trim each to 4-1/2" (2-1/2").

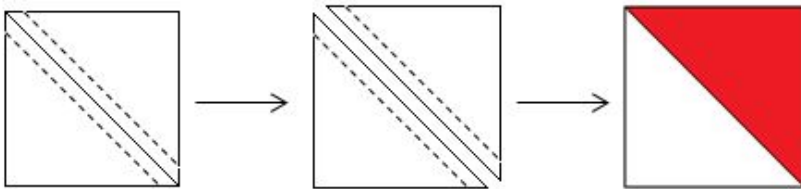

Making the quarter square triangles:

The portion of the block with the small triangles may not look like traditional quarter square triangles, but they are constructed in a very similar way. Draw a diagonal line from corner to corner on the 5-1/2" (3-1/2") background squares. Pair each square with a 5-1/2" (3-1/2") print square, right sides together. Sew 1/4" away from the line on both sides. Cut apart on the center lines and press towards the print fabric to create half square triangles (HST). You will have two HSTs of each print.

Next, pair each HST that you just created with the remaining 5" (3") background squares (if you have not already drawn diagonal lines on the background squares, do so now). You can trim your HSTs down to 5" (3") if you prefer, but it is not necessary. Center the smaller background square over the larger HST, keeping the points on two sides of the background square lined up with the seam of the HST, as shown below. Make sure your drawn line is perpendicular to the seam on the bottom piece. The only difference from traditional quarter square triangles is that your top piece is a solid square rather than another HST.

Make sure your drawn line on the solid square crosses the seam line of the HST (rather than being parallel). Sew 1/4" away from the line on both sides. Cut apart on the center lines and press towards the print fabric to create quarter square triangles (QST). You will have four QSTs of each print. Trim each to 4-1/2" (2-1/2"). Be careful when trimming to avoid cutting off the points of the print fabric.

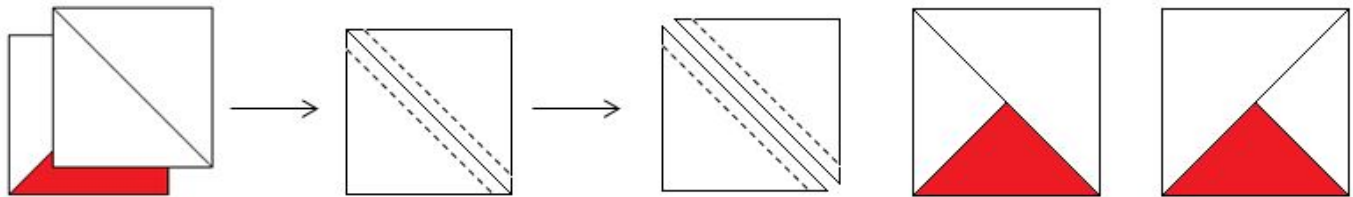

You may notice that the blocks are not exactly the same. When you cut your squares apart on the center line, you have one with a diagonal seam going in one direction and one with the seam going the opposite direction. Because three-fourths of the block is background, the blocks will look identical in the final block regardless of which way the final diagonal seam is going.

Assembling the block:

Gather all the pieces with the same print (4 HSTs and 4 QSTs) and a 4-1/2" (2-1/2") background square. Arrange the segments as shown below. Don't worry about the direction of that last diagonal seam in the QSTs. It does not matter which direction that seam is going in the block, as long as the print quarter of the segment is facing towards the center of the block. Sew the segments in three rows of three, pressing in the direction shown in the diagram. Sew the three rows together, pressing towards the middle row.

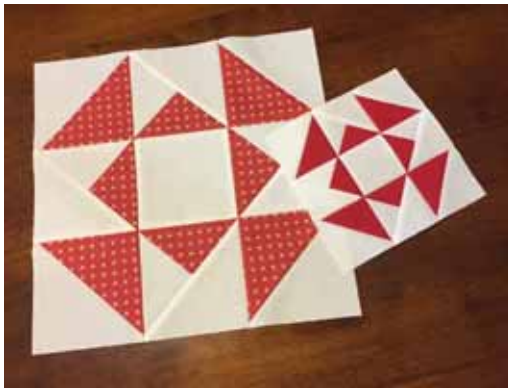
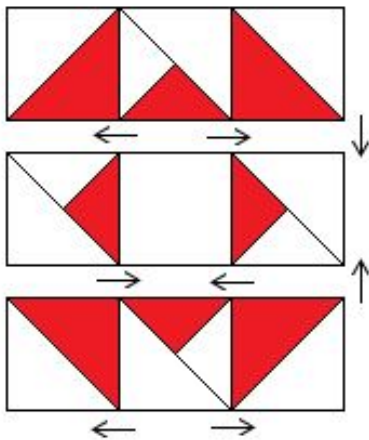

This block finishes at 6" or 12" square.

Thank you for joining me today! If you make this block and share it on Instagram, please tag me! ([@piecedjustsew](https://www.instagram.com/piecedjustsew)). I would love to see yours! Be sure to check back here tomorrow for the next Countdown to Christmas block by another Modabake Shop chef!

Amanda Wilbert

{blog: [Pieced Just Sew](http://PiecedJustSew.com)}

{instagram: [@piecedjustsew](https://www.instagram.com/piecedjustsew)}

{shop: [Pattern shop](http://PatternShop.com)}

11/30/2018

Original Recipe can be found at www.modabakeshop.com

Recipes are sometimes altered to correct errors. Please ensure that you have downloaded the most recent Printer Friendly Version before starting your project. If you find a mistake in this pattern, please contact modabakeshop@unitednotions.com.

This is an original pattern not intended for sale.

INGREDIENTS

6" Block

From white fabric, cut:

- (4) $2\frac{1}{16}$ " squares, cut in half diagonally to make eight (8) triangles
- (4) $2\frac{7}{8}$ " by $1\frac{11}{16}$ " rectangles

From solid red fabric, cut (5) $1\frac{11}{16}$ " squares

From red print, cut (2) $3\frac{1}{4}$ " squares, cut in half diagonally once to make 4 triangles

12" Block

From white fabric, cut:

- (4) $3\frac{1}{4}$ " squares, cut in half diagonally to make (8) triangles
- (4) $5\frac{5}{16}$ " by $2\frac{7}{8}$ " rectangles

From solid red fabric, cut (5) $2\frac{7}{8}$ " squares

From red print, cut two (2) $5\frac{5}{8}$ " square, cut in half diagonally once to make (4) triangles

INSTRUCTIONS

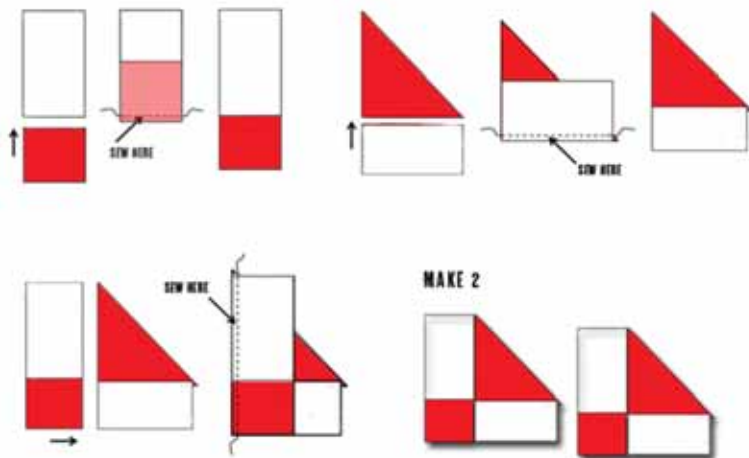

MAKE OUTER CORNER UNITS

- 1 - Sew 1 red square to 1 background rectangle. Press.
- 2 - Sew 1 background rectangle to 1 red triangle. Press.
- 3 - Join step 1 and step 2 units as shown. Repeat to make a total of two outer corner units.



MAKE CENTER UNIT

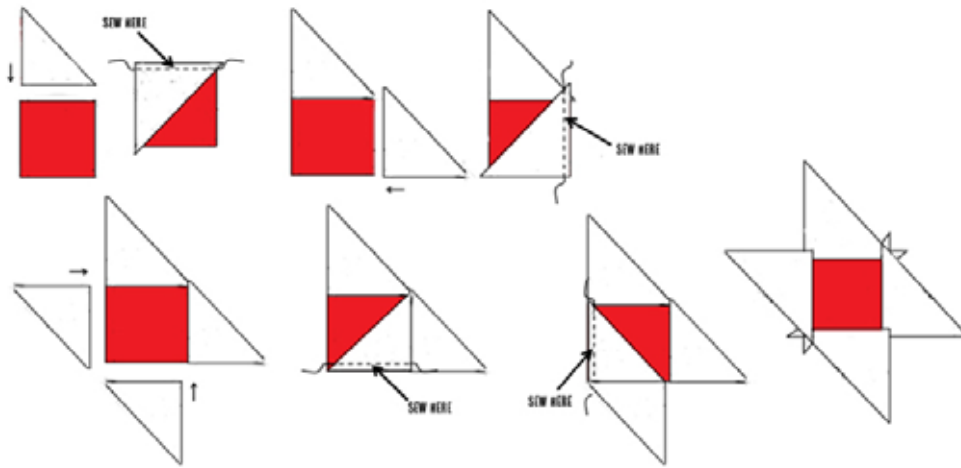

1 - Sew two background triangles to each red square. Press. Make three of these units and set two aside for INNER CORNERS.

2 - Sew two background triangles to each side of the center red square. Press.

MAKE INNER CORNERS

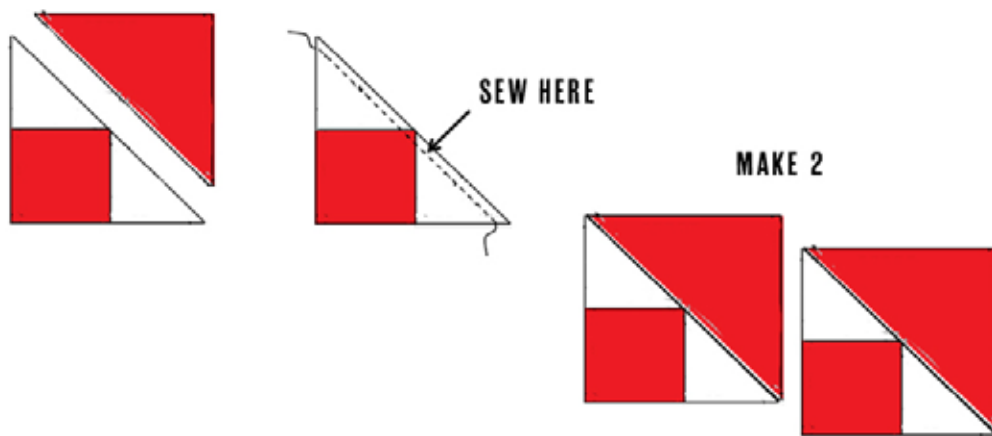

1 - Sew 1 red triangle to the extra unit set aside in CENTER UNIT step. Press. Repeat to make a total of two outer corner units.

ASSEMBLE BLOCK

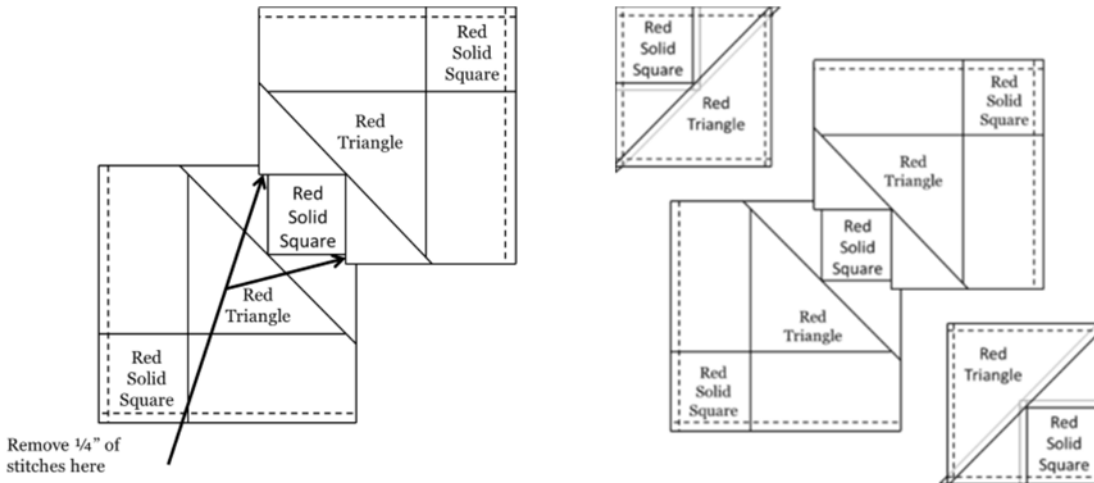

1 - Sew outer corner units to center unit. Remove the last $\frac{1}{4}$ " of stitches around the Red center square for ease of block assembly. Press seams toward the Red triangles.

2 - Begin sewing $\frac{1}{4}$ " from Red center square to end of unit. Repeat for other side. Sew all corner units. Press seams.



This block finishes at 6" or 12" square.
Candee Ferris

12/2/2018

Original Recipe can be found at www.modabakeshop.com

Recipes are sometimes altered to correct errors. Please ensure that you have downloaded the most recent Printer Friendly Version before starting your project. If you find a mistake in this pattern, please contact modabakeshop@unitednotions.com.

This is an original pattern not intended for sale.



INGREDIENTS

6" Block

From white fabric, cut (2) 3¼" squares
 From solid red fabric, cut (1) 3¼" square, (4) 1½" squares, (4) 1½" x 2½" rectangles and *(1) 2 1/2" square
 From red print, cut (1) 3¼" square, (4) 1½" squares
 *If you prefer, your center square may be fussy-cut from another red and white print.

12" Block

From white fabric, cut (2) 5¼" squares
 From solid red fabric, cut (1) 5¼" square, (4) 2½" squares, (4) 2½" x 4½" rectangles and *(1) 4 1/2" square.
 From red print, cut (1) 5¼" square, (4) 2½" squares
 *If you prefer, your center square may be fussy-cut from another red and white print.

INSTRUCTIONS

NOTE: The instructions below are for the 12" finished block, with changes for the 6" finished block in parentheses.



Step 1: Make Quarter Square Triangles (QSTs)

Cut each of the 5 1/4" (3 1/4") squares on the diagonal twice.
 Sew into 4 quarter square units as shown.



Step 2: Make Corner units

Sew the 2 1/2" (1 1/2") red solid and red print squares into pairs. Sew a 2 1/2" x 4 1/2" (1 1/2" x 2 1/2") rectangle to the right side of each pair of squares.



Step 3: Complete the block

Lay out the QSTs, Corner Units and the 4 1/2" (2 1/2") center square as shown. Sew the units into three rows, and then sew the rows together to complete your Prairie Christmas Star block. The solid red center square may be embroidered or otherwise embellished if you like.

YIELD

This block finishes at 6" or 12" square

Anne Wiens

[blog: Seams Like a Plan](#)

[facebook: SweetgrassCreativeDesigns](#)

12/2/2018

Recipes are sometimes altered to correct errors. Please ensure that you have downloaded the most recent Printer Friendly Version before starting your project. If you find a mistake in this pattern, please contact modabakeshop@unitednotions.com.

This is an original pattern not intended for sale.

Original Recipe can be found at www.modabakeshop.com



INGREDIENTS

6" Block

From the red fat quarter, cut (4) 2 ½" squares and (4) 2" squares

From the white fat quarter, cut (4) 2 ½" squares and (4) 2" squares.

12" Block

From the red fat quarter, cut (2) 3 ½" squares, (4) 4" squares, (4) 2 ½" squares, and (4) 2" squares

From the white fat quarter, cut (2) 3 ½" squares, (4) 4" squares, (4) 2 ½" squares, and (4) 2" squares

INSTRUCTIONS

We'll start by constructing the center star. This center star makes up the entirety of the 6" block and makes up the center portion of the 12" block. **So whether you're making the 6" or 12" block, follow the instructions below to make the center star.**

Gather the four red 2 ½" squares and the four white 2 ½" squares. Referring to the image below, follow the steps 1-4 to make (8) 2" half-square triangles.

1. Draw a line corner-to-corner on the wrong side of the white 2 ½" squares.
2. Pair a white square right sides together with a red 2 ½" square. Sew two seams, each 1/4" away from the drawn line.
3. Cut the pieces apart on the drawn line.
4. Press the seams open and trim the half-square triangles to 2" x 2". Repeat with the remaining 2 ½" squares to make a total of (8) 2" x 2" half-square triangles.

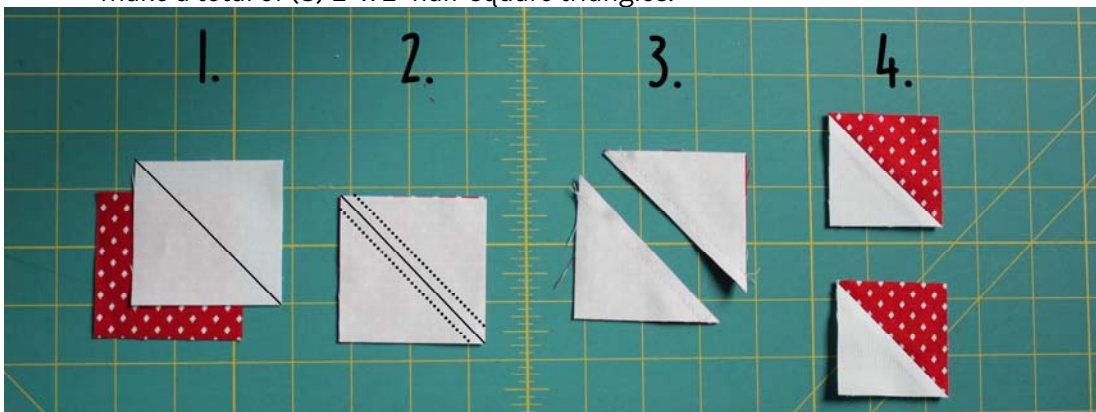

Using the figure below as a guide, lay out the (8) half-square triangles along with the (4) white 2" squares and the (4) red 2" squares.



Assemble each row, pressing the seams open.

Sew the rows together, pressing seams open to reduce bulk. The completed center star should measure 6 ½" square.

If you are making the 6" block, you are done! Yay!

If you are making the 12" block, continue on with the remaining directions.

Gather the (4) 4" white squares and the (4) 4" red squares. Referring to the image below, follow the directions to make (8) half-square triangles.

1. Draw a line corner-to-corner on the wrong side of the white 4" squares.
2. Pair a white square right sides together with a red 4" square. Sew two seams, each 1/4" away from the drawn line.
3. Cut the pieces apart on the drawn line.
4. Press the seams open and trim the half-square triangles to 4½" x 4½". Repeat with the remaining 4" squares to make a total of (8) 4½" x 4½" half-square triangles.

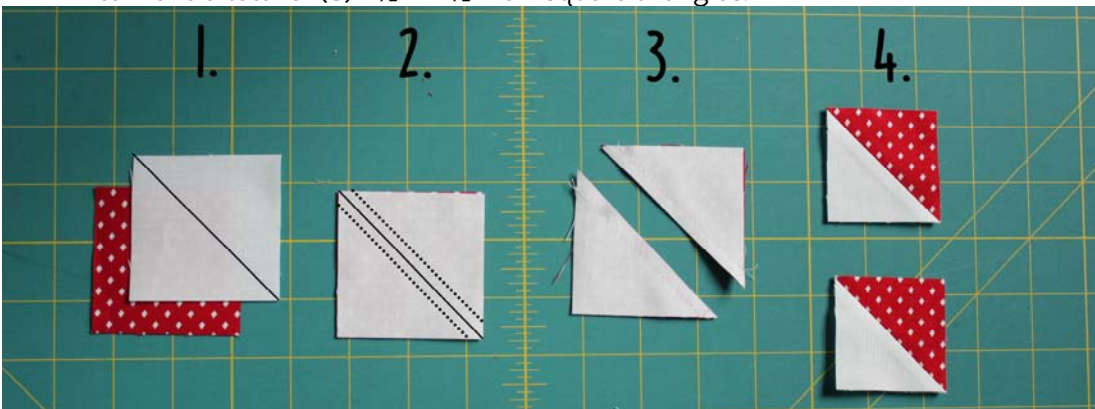

Gather the remaining red and white squares along with the (8) half-square triangles and the center square to lay out the block according to the image below.



Assemble the top and bottom rows and the left and right middle sections.

Sew the left and right middle sections to the center star unit.

Sew the top and bottom rows to the center section. The finished Regent Street Star quilt block should measure 12½" x 12½".



YIELD

This block finishes at 6" or 12" square (6 ½" or 12 ½" unfinished).



Thanks for following along with the Regent Street Star quilt block! I really enjoyed making my blocks and hope you do, too! Please share on instagram using the hashtag #centerstreetquilts so I can see all of your wonderful creations! Happy Holidays and make sure to check back tomorrow for the next Countdown to Christmas block. :)

Kristina Brinkerhoff

{blog: [Center Street Quilts](#)}

{instagram: [@centerstreetquilts](#)}

{shop: [Center Street Quilts on Etsy](#)}

12/2/2018

Original Recipe can be found at www.modabakeshop.com

Recipes are sometimes altered to correct errors. Please ensure that you have downloaded the most recent Printer Friendly Version before starting your project. If you find a mistake in this pattern, please contact modabakeshop@unitednotions.com.

This is an original pattern not intended for sale.



INGREDIENTS

6" Block

From white fabric, cut (8) 1 1/4" x 2" rectangles (A)
From solid red fabric, cut (2) 3" squares (C), (4) 2" squares (B)
From red print #1, cut: (1) 3 1/2" square (D)
From red print #2, cut (2) 3" squares (C)

12" Block

From white print fabric, cut (8) 2" x 3 1/2" rectangles (E)
From solid red fabric, cut (2) 4" squares (F), (4) 3 1/2" squares (G)
From red print #1, cut: (1) 6 1/2" square (H)
From red print #2, cut (2) 4" squares (F)

INSTRUCTIONS

The 6" and 12" blocks are made in the same way. Information for the 12" block is shown in parentheses.

NOTE: I added fabric from The North Pole? to the 6" block and Grunge and Red Dot...Green Dash to the 12" block.

1. Draw a diagonal line from corner to corner on the back of both red print #2 C (F) squares.

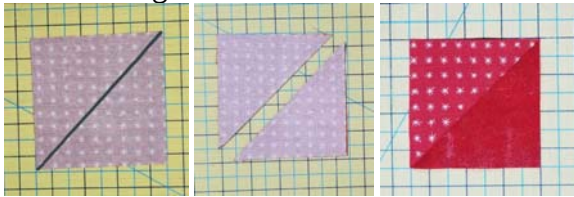

2. Place a solid red C (F) square and a red print #2 C (F) square right sides together. Stitch a scant 1/4" from both sides of the drawn line.

3. Cut apart on the drawn line and press open. Trim to 2" (3 1/2"). Make four HSTs.

4. Stitch a white A (E) to opposite sides of a red B (G). Make four.

5. Stitch a HST to opposite ends of the ABA (EGE) unit. Make two.

6. Stitch an ABA (EGE) unit to opposite side of D (H).

7. Layout the the rows and stitch together to complete your Wrapped Up block.

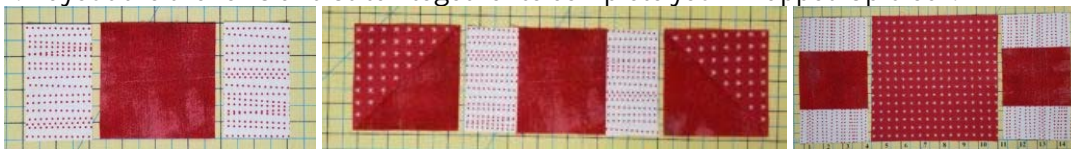

YIELD

This block finishes at 6" or 12" square.

Denniele Bohannon

{instagram: <https://www.instagram.com/dennielebohannon/?hl=en>}

{shop: <https://www.louannamaryquilt.com>}

{facebook: <https://www.facebook.com/louannamaryquilt.com>}

12/2/2018

Original Recipe can be found at www.modabakeshop.com

Recipes are sometimes altered to correct errors. Please ensure that you have downloaded the most recent Printer Friendly Version before starting your project. If you find a mistake in this pattern, please contact modabakeshop@unitednotions.com.

This is an original pattern not intended for sale.



INGREDIENTS

6" Block

From white solid fabric, cut: (2) 3" squares, (4) 2" squares, (4) 1½" squares
From red solid fabric, cut: (2) 3" squares, (5) 1½" squares
From red print, cut: (4) 2½" squares

12" Block

From white solid fabric, cut: (2) 4¾" squares, (4) 3½" squares, (4) 2½" squares
From red solid fabric, cut: (2) 4¾" squares, (5) 2½" squares
From red print, cut: (4) 4" square

INSTRUCTIONS

The following instructions are for the 6" block. The 12" block is made exactly the same way, but the 12" block patch sizes are listed in the brackets [].

Make Split Quarter Square Triangles (Split QSTs)

1. On the wrong side of a white 3" square [4¾" square] use a pencil to lightly draw a diagonal line from corner to corner. Layer the marked white 3" square [4¾" square] atop a solid red 3" square [4¾" square] with right sides together.

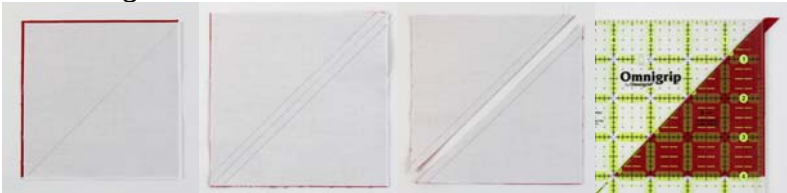

2. Stitch the pair together a scant ¼" from either side of the drawn line. Press to set seams.
3. Cut the unit in half on the drawn line to make 2 half square triangle units ("HSTs").
4. Press the seam allowances toward the red and trim the HST units to measure 2½" x 2½" [4" x 4"] unfinished.
5. On the wrong side of 2 red print 2½" squares [4" squares] use a pencil to lightly draw a diagonal line from corner to corner. Layer the 2 marked red print 2½" squares [4" squares] atop the white/red half square triangle units with right sides together. Make sure that the lines drawn on the red print squares are perpendicular to the seam between the white and red triangles on the HSTs.

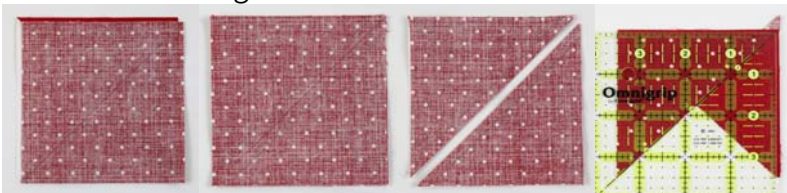

6. Stitch the pairs together a scant ¼" from either side of the drawn line. Press to set seams.
7. Cut the units in half on the drawn lines to make 4 split quarter square triangle units.
8. Press seam allowances toward the red print and trim the 4 split QSTs to 2" x 2" [3½" x 3½"] unfinished. Note that you'll end up with 2 split QSTs that are the mirror of the other 2.

9. Repeat with remaining white and red solid 3" squares [4¾" squares] and red print 2½" squares [4" squares] to make 8 split QSTs—4 with the white in one quarter and 4 with the white in an adjacent, or mirror, quarter.



Make Checkerboard (9-Patch) Center

1. Lay out 4 white and 5 red solid 1½" squares [2½" squares] in 3 rows of 3 squares each as shown.

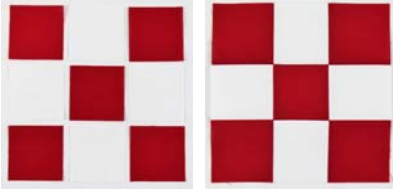

2. Join the pieces in each row, pressing seam allowances toward the red solid. Join the rows together, pressing seam allowances open, to make a checkerboard center measuring 3½" x 3½" [6½" x 6½"] unfinished.

Assemble Block

1. Join together 1 split QST and 1 mirror split QST as shown to make a split QST pair. Press seam allowances open.



2. Repeat to make 4 split QST pairs.

3. Sew a white 2" square [3½" square] to opposite ends of 2 split QST pairs to make a split QST row. Press seam allowances toward the white square.

4. Lay out 2 split QST rows, checkerboard center, and 2 split QST pairs in 3 rows as shown.

5. Sew a split QST pair to the left and right sides of the checkerboard center. Press seam allowances toward the checkerboard.



6. Sew a split QST row to the top and bottom of the unit from step 5. Press seam allowances toward the checkerboard.



This block finishes at 6" or 12" square.

Jen Daly

{blog: JenDalyQuilts.com}

{instagram: [jendalyquilts](https://www.instagram.com/jendalyquilts)}

{shop: [Etsy.com/shop/JenDalyQuilts](https://www.etsy.com/shop/JenDalyQuilts)}

{facebook: [jendalyquilts](https://www.facebook.com/jendalyquilts)}

12/3/2018

Original Recipe can be found at www.modabakeshop.com

Recipes are sometimes altered to correct errors. Please ensure that you have downloaded the most recent Printer Friendly Version before starting your project. If you find a mistake in this pattern, please contact modabakeshop@unitednotions.com.

This is an original pattern not intended for sale.



INGREDIENTS

6" Block

From white fabric, cut (8) 1½" squares, (8) 1½" x 2½" rectangles, (4) 1 7/8" squares
From solid red fabric, cut (1) 2½" square, (4) 1 7/8" squares
From red print #1, cut: (16) 1½" square

12" Block

6" Block

From white fabric, cut (8) 2½" squares, (8) 2½" x 4½" rectangles, (4) 2 7/8" squares
From solid red fabric, cut (1) 4½" square, (4) 2 7/8" squares
From red print #1, cut: (16) 2½" squares

INSTRUCTIONS

NOTE: The instructions below are for the 12" finished block, with changes for the 6" finished block in parentheses.

Make 8 Flying Geese

Gather the 8 white 2½" x 4½" rectangles (8 white 1½" x 2½" rectangles) and the 16 red print 2½" squares (16 red print 1½" squares). Lay one 2½" square (1½" square) RST on one 2½" x 4½" rectangle (1½" x 2½" rectangle). Draw a line from corner to corner on the red square, as shown below, and sew on that line.



Trim ¼" from the sewn line, as shown below.

Press open.

Repeat these steps on the other side of the 2½" x 4½" rectangle (1½" x 2½" rectangle).

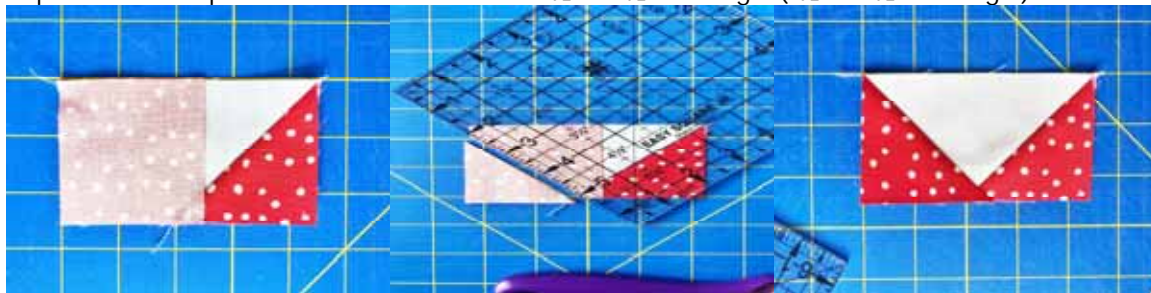

Repeat the above steps to make 8 flying geese total.

12/7/2018

Original Recipe can be found at www.modabakeshop.com
Recipes are sometimes altered to correct errors. Please ensure that you have downloaded the most recent Printer Friendly Version before starting your project. If you find a mistake in this pattern, please contact modabakeshop@unitednotions.com.

This is an original pattern not intended for sale.

Make 8 Half Square Triangles (HST)

Gather the 4 white 2 7/8" squares (4 white 1 7/8" squares) and the 4 red 2 7/8" squares (4 red 1 7/8" squares). Lay a red square on top of a white square, right sides together. Draw a line from corner to corner and sew 1/4" away from the center line on each side of it.



Cut on the center line.

Press open. Trim each HST to 2 1/2" square (1 1/2" square).

Repeat with the remaining squares you gathered so that you have 8 HST total.

Assemble the block

Gather the 8 flying geese, 8 HST, 1- red 4 1/2" square (2 1/2" square), 8 white 2 1/2" squares (1 1/2" squares) and lay them out as shown below.

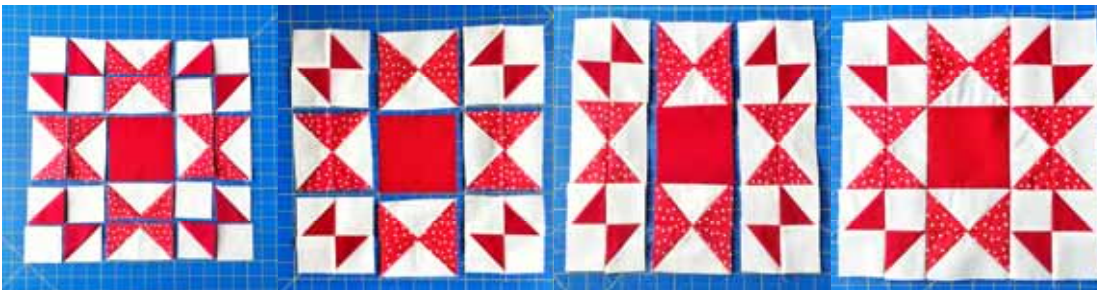

You can sew this block together any way you like. I prefer to sew mine together as a nine patch. To do that, sew the 4 squares in each corner together and the flying geese units together, shown below.

Sew the block together in rows.

Sew the rows together.



This block finishes at 6" or 12" square.

Thanks for following along with me today! I hope you enjoyed this block and continue to enjoy all of our Countdown to Christmas block patterns! Come, follow me, and see what I'm up to on Instagram [@jessicadayon](https://www.instagram.com/jessicadayon).

Jessica Dayon

{blog: [Jessica Dayon Blog](https://www.jessicadayonblog.com)}

{instagram: [@jessicadayon](https://www.instagram.com/jessicadayon)}

{shop: [Jessica Dayon Pattern Shop](https://www.jessicadayonpatternshop.com)}



NOTE: You will want either two red prints or a red solid and a print for this block in addition to your background fabric.

INGREDIENTS

6" Block

White or Low Volume White Fabric
8 - 1 ¼ inch squares
8 - 1 ¾ inch squares for flying geese
8 - 2 ¾ x 1 inch rectangles
Red Fabrics
12 - 1 ¼ inch squares
4 - 2 ¾ x 1 inch rectangles
2 - 2 ¾ inch squares for flying geese
1 - 2 inch square for center

12" Block

White or Low Volume White Fabric
8 - 2 inch squares
8 - 2 ½ inch squares for flying geese
8 - 5 x 1 ½ inch rectangles
Red Fabrics
12 - 2 inch squares
4 - 5 x 1 ½ inch rectangles
2 - 4 ¼ inch squares for flying geese
1 - 3/1/2 inch square for center

INSTRUCTIONS

The following instructions are for the 12 inch block. The 6 inch block is made exactly the same way, but the 6 inch block patch sizes are listed in the brackets []. All seams are ¼ inch and seams are pressed to the darker fabric.

Make 4 Four Patch Squares for the corners

Begin by making the 4 four patches for the corners. For each four patch corner use two 2 inch [1 ¼ inch] red squares and two 2 inch [1 ¼ inch] white squares.

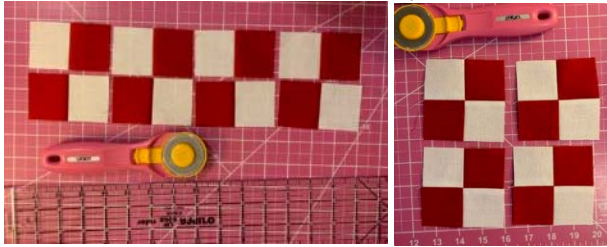

Make 8 Flying Geese

Use the 4 at a time no waste method to make the 8 flying geese. For each set of 4 flying geese uses 1 - 4 ¼ inch red square [2 ¾ inch red square] and 4 - 2 ½ inch white square [1 ¾ inch white squares].

Draw a diagonal line across the back of each of the 2 ½ inch [1 ¾ inch] white squares. Place 2 white squares on the right side of the red 4 ¼ inch [2 ¾ inch] square diagonally. Stitch ¼ inch on each side of the diagonal line through both of the white squares. Cut along the diagonal line and press open.



12/4/2018

Recipes are sometimes altered to correct errors. Please ensure that you have downloaded the most recent Printer Friendly Version before starting your project. If you find a mistake in this pattern, please contact modabakeshop@unitednotions.com.

This is an original pattern not intended for sale.

Original Recipe can be found at www.modabakeshop.com

On each of the new pressed open halves place a 2 ½ inch [1 ¾ inch] white squares on top aligning the edges with corner.

Sew a ¼ inch seam on each side of the drawn line. Repeat with the other half.

Cut along the diagonal line and press open.

Trim to 2 x 3 ½ inches [1 ¼ x 2 inches].

Repeat with the additional red 4 ¼ inch [2 ¾ inch] square and 4 -2 ½ inch white square [1 ¾ inch white squares] and make 4 more flying geese.

Assemble the corners

Sew a flying geese with the point pointing to the four patch on the top of one four patch and press

Sew one 2 inch [1 ¼ inch] red square one the side of another flying geese. Press. Repeat until the four corners are assembled.



Assemble the center pieces

Sew a 5 x 11/2 inch [2 3/4 x 1 inch] white strip on each side of a 5 x 11/2 inch [2 3/4 x 1 inch] red strip. Press



Assemble the block as shown below:

Note: be sure to align the red blocks so that they point toward the center.



This block finishes at 6" or 12" square.

Lisa Jo Girodat

{blog: [Neverlandstitches](#)}

{instagram: [neverlandstitches](#)}



INGREDIENTS

I made a scrappy little house using three different red fabrics and two different neutral prints. You can easily cut the required red pieces from a single fat quarter for a more uniform look.

1 fat quarter of background fabric

1 fat quarter of red fabric (or 1 fat quarter and scraps from two additional red fabrics)

Scraps of neutral fabric for door and window

6" Block

From background fabric, cut:

- (1) 2 ½" x 1½" rectangle
- (1) 4" x 1½" rectangle
- (1) 1" square
- (2) 2" squares
- (2) 4" x 1" rectangles

From red print #1 (chimney), cut (1) 1" square

From red print #2 (roof), cut (1) 6½" x 2" rectangle

From red print #3 (house), cut:

- (1) 5½" x 1½" rectangle
- (2) 3" x 1½" rectangles
- (1) 3" x 1" rectangle
- (2) 1½" x 1¼" rectangle

From neutral print #1 (door), cut (1) 3" x 2" rectangle

From neutral print #2 (window), cut (1) 1½" square

12" Block

From background fabric, cut:

- (1) 4½" x 2 ½" rectangle
- (1) 7 ½" x 2 ½" rectangle
- (1) 1½" square
- (2) 3½" squares
- (2) 7½" x 1½" rectangles

From red print #1 (chimney), cut (1) 1½" square

From red print #2 (roof), cut (1) 12½" x 3 ½" rectangle

From red print #3 (house), cut:

- (1) 10½" x 2½" rectangle
- (2) 5½" x 2½" rectangles
- (1) 5½" x 1½" rectangle
- (2) 2½" x 2" rectangle

From neutral print #1 (door), cut (1) 5½" x 3½" rectangle

From neutral print #2 (window), cut (1) 2½" square

INSTRUCTIONS

The 6" and 12" blocks are constructed using the same instructions. Measurements for the 6" blocks are listed first with the measurements for the 12" block in brackets.

Make Chimney Unit

Sew the 1" [1½"] square of Red #1 fabric to the 1" [1½"] square of background fabric, with the red fabric on the bottom. Press towards the red fabric. Sew the 2 ½" x 1½" [4½" x 2 ½"] rectangle of background fabric to the left side of the unit. Sew the 4" x 1½" [7 ½" x 2 ½"] rectangle of background fabric to the right side of the unit. Press towards background fabrics.



Make Roof Unit

Take the two 2" [3½"] squares of background fabric. Draw a line diagonally across the back of each one. Lay background squares on the ends of the 6½" x 2" [12½" x 3 ½"] rectangle of Red #2 RST with the diagonal lines extending from the bottom corners inward. Sew on the lines. Trim ¼" away from the sewn line and press towards the red fabric.

Make House Unit

Sew the 3" x 2" [5½" x 3½"] rectangle of Neutral #1 (the door piece) to one of the 3" x 1½" [5½" x 2½"] rectangles of Red #3. Press towards the red.

Sew a 1½" x 1¼" [2½" x 2"] rectangle of Red #3 to either side of the 1½" [2½"] square of Neutral #2 (the window piece). Press towards the red. Sew the 3" x 1" [5½" x 1½"] rectangle of Red #3 to the top of the unit. Sew the 3" x 1½" [5½" x 2½"] rectangle of Red #3 to the bottom of the unit. Press towards the long red pieces.

Sew the window unit to the door unit.

Sew the 5½" x 1½" [10½" x 2½"] rectangle of Red #3 to the top of the unit.

Sew a 4" x 1" [7½" x 1½"] rectangle of background fabric to each side of the unit.



Join Sections Together

Sew the three units together to form the block.



This block finishes at 6" or 12" square.



I hope you're having fun counting down to Christmas the quilting way.

Christine Weld

{blog: [The Quarter Inch](#)}

{instagram: [@Christine.Weld](#)}

{shop: [Craftsy](#)}

12/9/2018

Original Recipe can be found at www.modabakeshop.com

Recipes are sometimes altered to correct errors. Please ensure that you have downloaded the most recent Printer Friendly Version before starting your project. If you find a mistake in this pattern, please contact modabakeshop@unitednotions.com.

This is an original pattern not intended for sale.



INGREDIENTS

6" Block

From white fabric, cut
(12) 1 1/4" x 1 1/4" squares labeled A
(6) 1 1/4" x 2 3/4" rectangles labeled B
From red fabric, cut
(6) 1 1/4" x 1 1/4" squares labeled C
(2) 1" x 2 3/4" rectangles labeled D
(3) 1" x 5 1/2" rectangles labeled E
(2) 1" x 6 1/2" rectangles labeled F

12" Block

From white fabric, cut
(12) 2" x 2" squares labeled A
(6) 2" x 5" rectangles labeled B
From red fabric, cut
(6) 2" x 2" squares labeled C
(2) 1 1/2" x 5" rectangles labeled D
(3) 1 1/2" x 10 1/2" rectangles labeled E
(2) 1 1/2" x 12 1/2" rectangles labeled F



INSTRUCTIONS

We will start by making our 3 patch units. Layout 2 A and 1 C squares as shown below. Place the C square onto the first A square with right sides together and stitch a 1/4" seam along the edge. Then place the second A square on the C square with right sides together and stitch a 1/4" seam along the edge. Press the seam allowances in towards the C square. Repeat to make a total of six 3 Patch units.

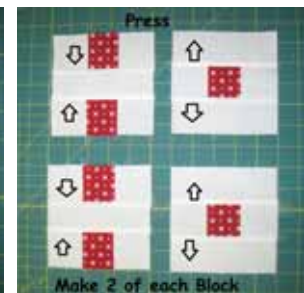
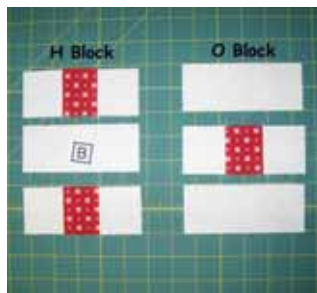

Layout two 3 Patch units and 1 B rectangle as shown below to make an H Block. Layout 2 B rectangles and one 3 Patch unit as shown below to make an O block.

Place the first row in each block onto the center row with right sides together as shown below in the H block. Stitch a 1/4" seam along the edge. Then place the third row in each block onto the center row with right sides together as shown in the O Block. Stitch a 1/4" seam along the edge.

Press the seam allowances in the H Block inwards towards the B rectangle. Press the seam allowances in the O block outwards towards the B rectangles. Repeat to make a total of 2 H Blocks and 2 O Blocks.

Layout 2 D Rectangles, 2 H Blocks, and 2 O blocks as shown below.

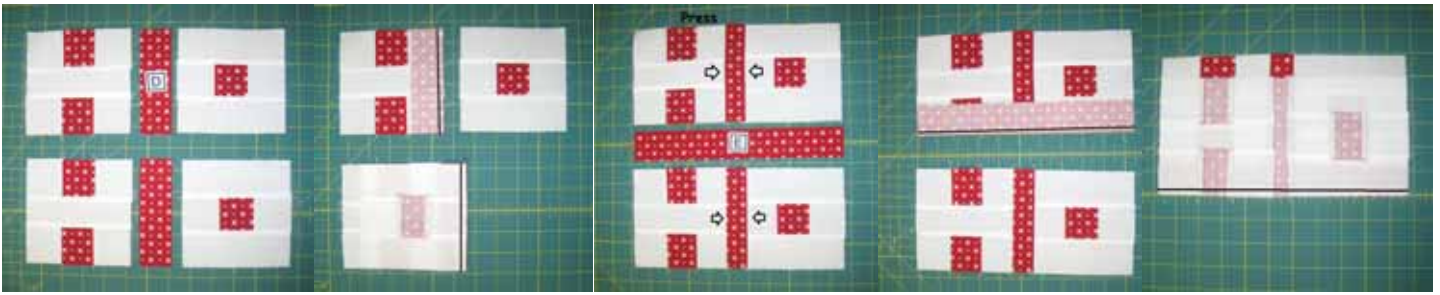

Place the D rectangles onto the H Blocks with right sides together as shown in the first row. Stitch a 1/4" seam along the edge. Then place the O Blocks onto the D rectangles with right sides together as shown below in the second row. Stitch a 1/4" seam along the edges.

Press the seam allowances inwards towards the D rectangles. Layout an E rectangle between your two rows as shown below.

Place the E rectangle onto the first row as shown. Stitch a 1/4" seam along the edge.

Now place the Second row onto the E rectangle with right sides together as shown. Stitch a 1/4" seam along the edge.

Press the seam allowances inwards towards the E rectangle. Layout two E rectangles on either side of the block as shown.



Place the E rectangles onto the sides of the block as shown below. Stitch a 1/4" seam along the edges.

Press the seam allowances outwards towards the E rectangles. Layout two F rectangles on the top and bottom of the block as shown below.

Place the F rectangles onto the top and bottom of the block as shown below. Stitch a 1/4" seam along the edges.

Press the seam allowances outwards towards the F rectangles. And just like that, you are done!!!!



This block finishes at 6" or 12" square. Doesn't the 6" block look so cute and tiny next to the 12" block!! I just love tiny piecing!!!

I hope you have enjoyed this tutorial and if you make your own Jolly St. Nick Block I would love to see it!! You can email me a picture at happyquiltingmelissa@gmail.com or post it to social media with #happyquiltingwithmc. I can't wait to see your Jolly St. Nick Blocks!!!

Merry Christmas!!!

Melissa Corry

{blog: [HappyQuilting](http://HappyQuilting.com)}

{instagram: [happyquiltingmc](https://www.instagram.com/happyquiltingmc)}

12/9/2018

Original Recipe can be found at www.modabakeshop.com

Recipes are sometimes altered to correct errors. Please ensure that you have downloaded the most recent Printer Friendly Version before starting your project. If you find a mistake in this pattern, please contact modabakeshop@unitednotions.com.

This is an original pattern not intended for sale.



INGREDIENTS

6" Block

From white fabric, cut (2) 1" x 21" strips, (2) 1½" x 1½" squares, (1) 1½" x 2½" rectangle, (1) 1½" x 4½" rectangle, (2) 1½" x 6½" rectangles, (1) 4½" x 4½" square.

From solid red fabric, cut (2) 1½" x 1½" squares

From red print, cut: (2) 1" x 21" strips

12" Block

From white fabric, cut (3) 1½" x 21" strips, (2) 2½" x 2½" squares, (1) 2½" x 4½" rectangle, (1) 2½" x 8½" rectangle, (2) 2½" x 12½" rectangles, (1) 8½" x 8½" square.

From solid red fabric, cut (2) 2½" x 2½" squares

From red print, cut: (3) 1½" x 21" strips

INSTRUCTIONS

I will include the measurements for both blocks during this explanation by listing the 6" requirements first, followed by the 12" requirements inside of {}.

Make Flying Goose

Take the (1) 1½" x 2½" {(1) 2½" x 4½"} white rectangle. Place (1) 1½" x 1½" {(1) 2½" x 2½"} red square on top of this, lining up with the right side. Sew down the center of the red square. Repeat for the other side until you have 1 flying goose unit that measures 1½" x 2½" {2½" x 4½"}. This will become the bow of your present.



Make Present

Take the 4½" x 4½" {8½" x 8½"} base piece. Center as best as you can (1) 1" x 21" {(1) 1½" x 21"} red print on it diagonally. I chose to pin along the left side edge of this piece to hold it in place.



Place (1) 1" x 21" {(1) 1½" x 21"} white piece on top of this. You will then sew along the right hand side using a ¼" seam allowance. Leave yourself a bit of room and then trim off the excess red and white strip so they can be used in the next steps.

Press this toward the white piece. Take the leftover red print you trimmed off and repeat this process.



Continue alternating red and white until you have reached the corner.

You will now repeat this process on the other half of this base piece until you have covered the entire base with these red and white strips.

Move to your cutting mat, flip this over so the wrong side is facing up, and then trim along the edges of the base.

Your present is now complete and you are ready to assemble your block using your $4\frac{1}{2}$ " x $4\frac{1}{2}$ " ($8\frac{1}{2}$ " x $8\frac{1}{2}$ ") present box.

Block Assembly

Attach (1) $1\frac{1}{2}$ " x $1\frac{1}{2}$ " ($2\frac{1}{2}$ " x $2\frac{1}{2}$ ") white square to both sides of the flying goose bow.



Attach the (1) $1\frac{1}{2}$ " x $4\frac{1}{2}$ " ((1) $2\frac{1}{2}$ " x $8\frac{1}{2}$ ") rectangle on to the top of the bow unit.

Sew the bow unit on to the present box.

The last step is to sew (1) $1\frac{1}{2}$ " x $6\frac{1}{2}$ " ((1) $2\frac{1}{2}$ " x $12\frac{1}{2}$ ") rectangles on to both sides of the present.



This block finishes at 6" or 12" square.



I LOOOOVE how this block turned out, so much more than I imagined. I have grand plans to make a really colorful version (think aqua, pink, green, red, blue) for my family as a Christmas quilt. I think this would be such a fun scrap buster quilt.

Jen Van Orman

{blog: [Heritage Threads](#)}

{instagram: [Heritage Threads](#)}

{shop: [Etsy pattern shop](#)}

12/4/2018

Original Recipe can be found at www.modabakeshop.com

Recipes are sometimes altered to correct errors. Please ensure that you have downloaded the most recent Printer Friendly Version before starting your project. If you find a mistake in this pattern, please contact modabakeshop@unitednotions.com.

This is an original pattern not intended for sale.

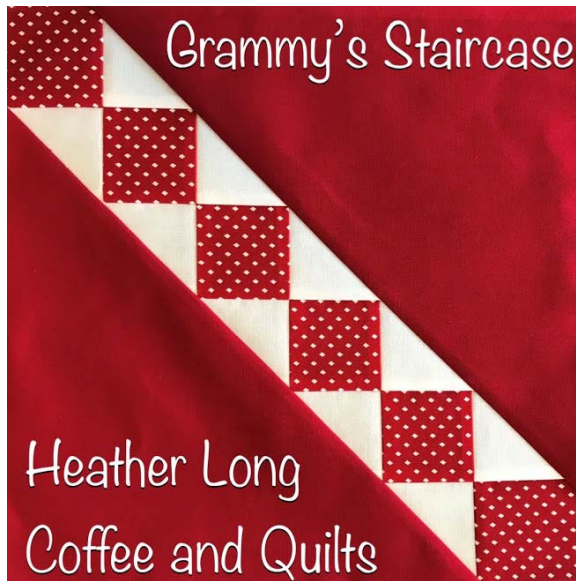

NOTE: You will want either two red prints or a red solid and a print for this block in addition to your background fabric.

INGREDIENTS

6" Block

From white fabric, cut (5) 2" squares, cut once on the diagonal
From solid red fabric, cut (1) 6" square, cut once on the diagonal
From red print #1, cut: (6) 1 1/2" squares

12" Block

From white fabric, cut (5) 3" squares, cut once on the diagonal
From solid red fabric, cut (1) 11" square, cut once on the diagonal

From red print #1, cut: (6) 2 1/2" squares



Layout the block, taking care with any directional prints.

INSTRUCTIONS

First, we'll sew the red print squares to the solid white triangles. Skip the uppermost red print square for now. Flip the second square from the top to the left, right sides together with a white triangle.



I find it easiest to always work with square edges when possible. Sew quarter inch seam allowance. Sew the remaining four red prints squares to their corresponding triangles in the same manner. Press towards the red.
At this point, I like to rotate my cutting mat where I have my pieces arranged 180-degrees, so I can work top to bottom again.
Our top stair is completed, so working as before, flip the second red print square to the left, and align with a solid white triangle.
Sew quarter inch seam, and repeat with remaining four red print squares. Press towards red again.
Trim the dog ears from your blocks.



Arrange your stairs.

12/4/2018

Original Recipe can be found at www.modabakeshop.com

Recipes are sometimes altered to correct errors. Please ensure that you have downloaded the most recent Printer Friendly Version before starting your project. If you find a mistake in this pattern, please contact modabakeshop@unitednotions.com.

This is an original pattern not intended for sale.

Fold the top stair unit down, right sides together with the second stair. Your seams will nest.
Sew together with a quarter inch seam. Repeat to sew all stairs together, checking alignment and that seams are nesting. Press seams in one direction.
Use the 45 degree line on your ruler and trim off excess white triangles, leaving quarter inch seam allowance.



Repeat on the opposite side.

Sew a solid red triangle on each side, making sure to take care sewing bias edges. Your red triangle will extend at least one quarter inch on each side.



Press towards red triangles.
Square and trim.



This block finishes at 6" or 12" square.

Thank you for Counting Down to Christmas with me! Please visit my blog and follow me on instagram to see what I'm up to. I'd love to see your finished #grammysstaircase blocks.

Heather Long

{blog: [Coffee and Quilts](#)}

{instagram: [Coffee and Quilts](#)}

{shop: [Coffee and Quilts](#)}

{facebook: [Coffee and Quilts](#)}

12/4/2018

Original Recipe can be found at www.modabakeshop.com

Recipes are sometimes altered to correct errors. Please ensure that you have downloaded the most recent Printer Friendly Version before starting your project. If you find a mistake in this pattern, please contact modabakeshop@unitednotions.com.

This is an original pattern not intended for sale.



NOTE: You will want either two red prints or a red solid and a print for this block in addition to your background fabric.

INGREDIENTS

6" Block

From white fabric, cut (2) 1 1/2" X 22" strips
From red print #1 fabric, cut (1) 2" square, (1) 1 1/2" X 22" strip,
From red print #2, cut: (1) 1 1/2" X 22" strips

12" Block

From white fabric, cut (8) 1 1/2" X 22" strips
From red print #1 fabric, cut (4) 2" squares, (4-5) 1 1/2" X 22" strips
From red print #2, cut: (4-5) 1 1/2" X 22" strips



INSTRUCTIONS

1. Cut the squares and strips for the number of blocks you need. A 12" block is (4)-6" blocks.
2. The piecing of the log cabin block is counter clockwise. Lay the 2" center square with the 1st red strip (I cut a piece a little larger than the 2" square), to the right of the square, stitch, press seam out from center.



3. Lay the 2nd red strip on the top of the unit (again I cut a piece a little larger than the unit), stitch, press seam out from the center.
4. Lay the white strip to the left of the unit (cut a piece off), stitch, press out from the center.
5. Lay the white strip on the bottom of the unit (cut a piece off), stitch, press out from the center.
6. Using a Creative Grids Ruler trim as directed. If using a rotary cutting ruler, center the center square and trim the unit to 3 1/2" X 3 1/2".
7. Continue to add the strips as above for two more rounds. After the second round of strips added, trim your block to 5" X 5". Following the third round, trim your block to 6 1/2" X 6 1/2".
8. For a 12" block choose a layout for the (4)-6" blocks. See the 3 Layouts suggested in the photos. Join the blocks in pairs, the join the pairs with opposing seams. Press the final block seams to create the least bulk.



YIELD

This block finishes at 6" or 12" square.

Pam Mildren

{instagram: [@PamMildren](#)}

{shop: [Longarm Quilting by Pam](#)}

{facebook: [Longarm Quilting by Pam](#)}

12/4/2018

Recipes are sometimes altered to correct errors. Please ensure that you have downloaded the most recent Printer Friendly Version before starting your project. If you find a mistake in this pattern, please contact modabakeshop@unitednotions.com.

This is an original pattern not intended for sale.

Original Recipe can be found at www.modabakeshop.com



INGREDIENTS

6" Block

From white fabric, cut (1) 2½" x 5" piece, (1) 2½" x 3" piece, (1) 2" x 4½" piece, (1) 2" square, (1) 1½" square, (1) 1" x 3" piece, (1) 1" x 1½" piece and (1) 1" square

From solid red fabric, cut (1) 2½" x 5" piece, (1) 2" x 4" piece, (2) 2" x 3" pieces and (1) 1" square

12" Block

From white fabric, cut (1) 4½" x 9½" piece, 4½" x 5½" piece, (1) 3½" x 8½" piece, (1) 3½" square, (1) 2½" square, (1) 1½" x 5½" piece, (1) 1½" x 2½" piece and (1) 1½" square

From red print fabric, cut (1) 4½" x 9½" piece, (1) 3½" x 7½" piece, (2) 3" x 5" pieces and (1) 1½" square

GARNISHES

- White embroidery floss
- Embroidery/chenille needle
- Water soluble pen to mark your design

INSTRUCTIONS

Sizes are given for the 12" block, with the sizes for the 6" block in brackets {}. Directions are given to make a red horse on a white background, but feel free to reverse the colours.

1. To create the horse's body, mark a diagonal line on the back of the 1½" {1"} background square and pin, right sides together, on the top right-hand corner of the 4½" x 9½" {2½" x 5"} red piece. Stitch on the line, flip 'open' and press, trimming away the back layers ¼" away from the seam, to make an Easy Corner Triangle (ECT).



2a. To create the horse's legs, first prepare the (2) 3" x 5" {2" x 3"} red pieces by placing them right sides together and marking a point 1¼" {¾"} along the short side (marked in blue). Trim diagonally, discarding the smaller portions. You should have two mirror image pieces.

2b. Prepare the 4½" x 9½" {2½" x 5"} background piece by marking points 2" {1"} from both corners of the long side and 1" {½"} from both corners of the opposite side. Using those points, mark placement lines, shown in blue.

2c. Position a trimmed red piece right sides down on the placement line and stitch a ¼" away from the edge before flipping 'open' and pressing (the stitching line is marked in blue). Turn your unit to the wrong side and trim, using the background piece as a guide. Repeat to create the other leg.



12/9/2018

Original Recipe can be found at www.modabakeshop.com
Recipes are sometimes altered to correct errors. Please ensure that you have downloaded the most recent Printer Friendly Version before starting your project. If you find a mistake in this pattern, please contact modabakeshop@unitednotions.com.

This is an original pattern not intended for sale.

3. To create the horse's head form an ECT (as described in step 3) with the $3\frac{1}{2}$ " {2"} white square at one end of the $3\frac{1}{2}$ " x $7\frac{1}{2}$ " {2" x 4"} red piece, taking care with the placement, as shown. Then form an ECT with the $2\frac{1}{2}$ " {1½"} white square at the other end, again as shown.



4. To create the horse's ear form an ECT with the $1\frac{1}{2}$ " {1"} red square at one end of the $1\frac{1}{2}$ " x $5\frac{1}{2}$ " {1" x 3"} white piece, taking care with the placement as shown. Then join a $1\frac{1}{2}$ " x $2\frac{1}{2}$ " {1" x 1½"} piece, pressing away from the ear.

5a. To assemble the block, join the legs to the body, pressing away from the leg, then join a $3\frac{1}{2}$ " x $8\frac{1}{2}$ " {2" x 4½"} white piece to the side, pressing away from the front leg.

5b. Join the ears to the head, pressing away from the ear, then join a $4\frac{1}{2}$ " x $5\frac{1}{2}$ " {2½" x 3"} white piece to the side, pressing away from the mane. Finally, join both sections together, pressing towards the head.

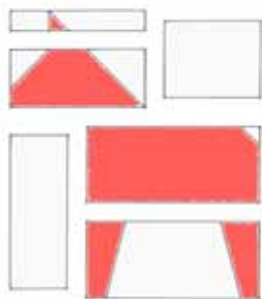

6. If you'd like to, add the reins and saddle with white embroidery floss. I used simple back-stitch and running-stitch to embroider the 6" block and you can download the template I used [here](#).



This block finishes at 6" or 12" square.

I'm hoping to use my blocks to make some Christmas gift bags and I'll be sharing a tutorial on my blog next week if you'd like to do the same. Small gift bags would be perfect to use as an advent calendar, using all of the gorgeous blocks posted this month! But however you use yours, do come and say hello on Instagram and share your blocks with the [#mbscountdowntochristmas](#) hashtag.

Wishing you all very Merry Christmas and a Happy New Year,

Nicola Dodd

{blog: [Nicola's Sketchbook](#)}

{instagram: [nicolajdodd](#)}

{shop: [CakeStand Quilts](#)}

Countdown to Christmas

Dala Horse Embroidery Template

Template shown for 6" block. Enlarge by 200% for use with a 12" block.

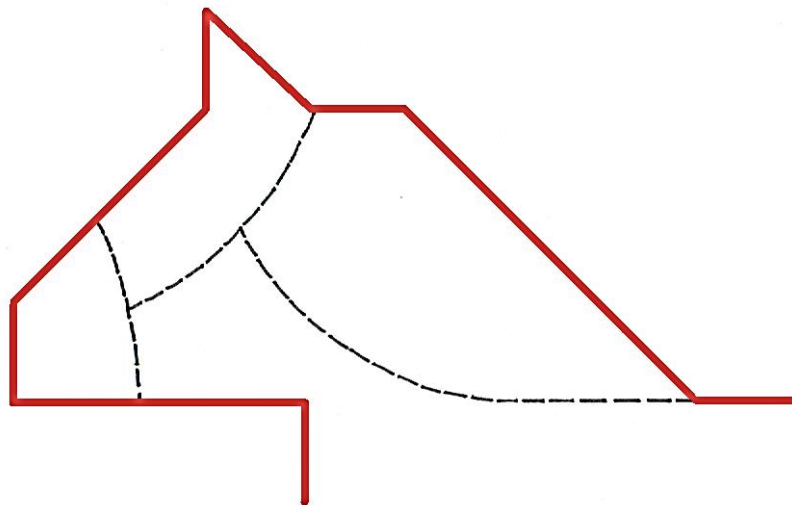
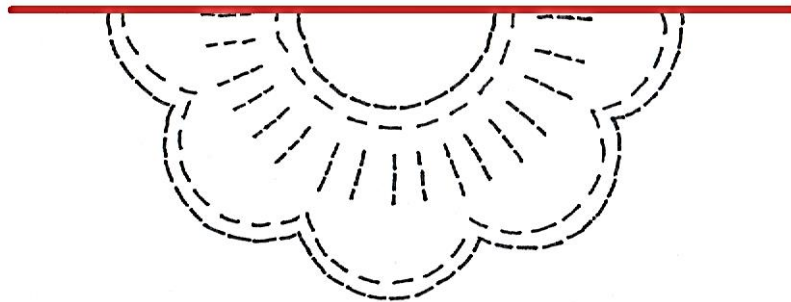



INGREDIENTS

6" Block

From white fabric, cut (2) 3" squares and (4) 1-1/2 x 2-1/2" rectangles
From solid red fabric, cut (4) 1-1/2 x 2-1/2" rectangles
From red print, cut: (2) 3" squares and (1) 2-1/2" square

12" Block

From white fabric, cut (2) 5" squares and (4) 2-1/2 x 4-1/2" rectangles
From solid red fabric, cut (4) 2-1/2 x 4-1/2" rectangles
From red print, cut: (2) 5" squares and (1) 4-1/2" square

INSTRUCTIONS

Start by cutting the squares and rectangles you need according to the size you are making. I find it easier to cut a long strip for the rectangles, sew the two colors together and then cross cut into the smaller units.



Draw sewing lines 1/4" away from the center on the diagonal across the back of the white squares. Pair them right sides together with the red print and sew 1/4" away from the line on both sides. =

Cut the triangles apart and press to the red side. Pair the white rectangles with the solid red rectangles and sew along the long side with a 1/4" seam. (Or, if you did one long strip, cross cut into the proper size.) Press to the red side.

For the 6-inch block, the units should measure 2-1/2" square, and for the 12-inch block, the units should measure 4-1/2" square. Use a square up ruler to trim your units to the correct size if needed.



Arrange the half square triangle units, the rectangle units and the smaller red print square as shown.

Sew in rows, pressing the seams on the top and bottom rows in the opposite direction from the middle row to allow nesting of seams. Sew the rows together.

All done, now you have a Shining Star for your sampler Countdown to Christmas quilt! The 12-inch size would also make a nice center to a set of placemats with a Christmas print border. The smaller size could be made into a mug rug for a quick hostess gift.

Make a quilt of Shining Stars and see the twinkles form between the blocks.

YIELD

This block finishes at 6" or 12" square.

Carole Carter

{blog: [FromMyCarolinaHome](#)}

{shop: [FromMyCarolinaHome on Craftsy](#)}

{facebook: [FromMyCarolinaHome](#)}

12/9/2018

Original Recipe can be found at www.modabakeshop.com

Recipes are sometimes altered to correct errors. Please ensure that you have downloaded the most recent Printer Friendly Version before starting your project. If you find a mistake in this pattern, please contact modabakeshop@unitednotions.com.

This is an original pattern not intended for sale.



INGREDIENTS

6" Block

From white fabric, cut (1) $4\frac{1}{4}$ x $11\frac{1}{8}$ " rectangle, (2) $1\frac{3}{4}$ " squares, (1) $11\frac{1}{8}$ " x $1\frac{3}{4}$ " rectangle, (4) $11\frac{1}{8}$ " squares, (2) $2\frac{1}{2}$ " squares (subcut in half on the diagonal), (2) $6\frac{1}{2}$ " x $11\frac{1}{2}$ " rectangles, (2) $5\frac{1}{2}$ " x $11\frac{1}{2}$ " rectangles
From solid red fabric, cut (1) $4\frac{1}{4}$ x $11\frac{1}{8}$ " rectangle, (2) $11\frac{1}{8}$ " x $1\frac{3}{4}$ " rectangles, F
From red print #1, cut (1) $2\frac{3}{8}$ " square
From red print #2, cut (1) $11\frac{1}{8}$ " x 3" rectangle, (6) $11\frac{1}{8}$ " squares
From red print #3, cut: (2) $4\frac{1}{4}$ x $11\frac{1}{8}$ " rectangles

12" Block

From white fabric, cut (1) 8 x $13\frac{3}{4}$ " rectangle, (2) 3" squares, (1) $13\frac{3}{4}$ " x 3" rectangle, (4) $13\frac{3}{4}$ " squares, (2) $3\frac{5}{8}$ " squares (subcut in half on the diagonal), (2) $12\frac{1}{2}$ " x 2" rectangle, (2) $10\frac{1}{2}$ " x 2" rectangle
From solid red fabric, cut (1) 8 x $13\frac{3}{4}$ " rectangle, (2) $13\frac{3}{4}$ " x 3" rectangles
From red print #1, cut (1) $4\frac{3}{8}$ " square
From red print #2, cut (1) $13\frac{3}{4}$ " x $5\frac{1}{2}$ " rectangle, (6) $13\frac{3}{4}$ " squares
From red print #3, cut (2) 8 x $13\frac{3}{4}$ " rectangles

INSTRUCTIONS

Notes:

- The instructions below are for the 6" finished block. The measurements for the 12" block are in brackets [].
- It is best to use a scant $\frac{1}{4}$ " for all seams. If your measurements are off, we'll be able to make up a little bit at the end with the borders.
- Press all seams open unless noted. This will help the red fabric not shadow behind the white and will also help with bulky seams.

Center of the Mug

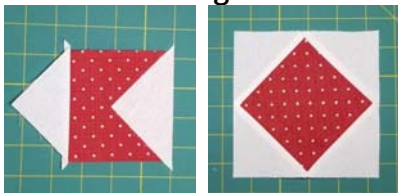

Starting with your Red Print #1 - $2\frac{3}{8}$ " square [$4\frac{3}{8}$ " square] fabric piece, sew the 4 white triangles (subcut from the $2\frac{1}{2}$ " squares [$3\frac{5}{8}$ " squares]) onto each side. Start by sewing opposite sides (right and left) first, making sure to center the triangle on the block.

Press seams open. Then sew on the remaining two triangles.

Trim to 3" [$5\frac{1}{2}$ "] square.

Mug Body

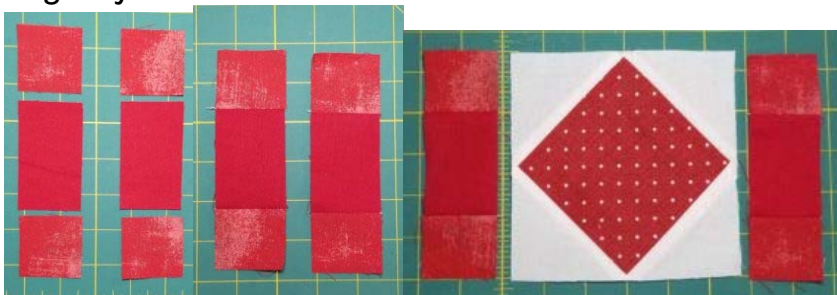

Sew 2 Red Print #2 - 1 1/8" [1 3/4"] squares onto the short end of each the solid red 1 1/8" x 1 3/4" [1 3/4" x 3"] rectangles. Press seams open.

Sew each of these units to the center portion.

Next, you make the bottom curve of the cup. Take 2 of the 1 1/8" [1 3/4"] squares] white squares and draw a line diagonally from one corner to another. Then lay these on one of the Red Print #3 - 4 1/4 x 1 1/8" [8 x 1 3/4"] rectangles as show below. Sew on the diagonal.



Trim the unit 1/4" on the exterior of where you've sewn and press open.

Now, you will assemble the pieces of the mug body as shown below:

Mug Handle

Sew two of the Red Fabric #2 - 1 1/8" [1 3/4"] squares to one white 1 1/8" x 1 3/4" [1 3/4" x 3"] rectangle, in order as shown below:

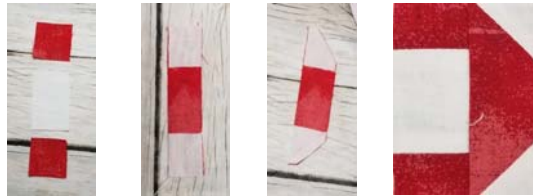

Next, take 2 of the 1 1/8" [1 3/4"] squares] white squares and draw a line diagonally from one corner to another. Lay these on the Red Print #2 - 1 1/8" x 3" [1 3/4" x 5 1/2"] rectangle as shown below. Sew on the diagonal and trim. Then sew these units together.

Sew 2 of the white 1 3/4" [3"] squares on both ends of this unit, resulting in the handle portion of the block.

Final Assembly and Borders

There are only a couple of steps remaining!

Sew together your mug body and mug handle, making sure to line up the seams where the lines of the body match up to the seams of the handle.



For the borders, sew the two white 5 1/2" x 1 1/2" [10 1/2" x 2] rectangles to both sides of your block; then the two white 6 1/2" x 1 1/2" [12 1/2" x 2"] rectangles to the top and bottom. And - you're done!



This block finishes at 6" or 12" square.

I hope that you enjoy this block as much as I do! Wishing you and yours a wonderful Christmas season and have a Cup of Cheer!

Thanks for reading along. Please [follow me on Instagram](#) to keep up with my latest projects.

Mona Phelps

[blog: [Kentucky Whittaker Creations](#)]

[instagram: [@mona.phelps](#)]

[facebook: [facebook.com/ky.whittaker.creations](#)]

12/16/2018

Original Recipe can be found at [www.modabakeshop.com](#)

Recipes are sometimes altered to correct errors. Please ensure that you have downloaded the most recent Printer Friendly Version before starting your project. If you find a mistake in this pattern, please contact [modabakeshop@unitednotions.com](#).

This is an original pattern not intended for sale.



INGREDIENTS

6" Block

From white fabric, cut: (4) 2" x 3½" rectangles, (9) 2" x 2" squares

From solid red fabric, cut: (5) 2" x 2" squares

From red print, cut: (8) 2" x 2" squares

12" Block

From white fabric, cut: (4) 3½" x 6½" rectangles, (4) 3½" x 3½" squares, (5) 3" x 3" squares

From solid red fabric, cut: (5) 3" x 3" squares

From red print, cut: (8) 3½" x 3½" squares

INSTRUCTIONS

The following instructions are for the 6" block. The 12" block is made exactly the same way, but the 12" block patch sizes are listed in the brackets [].

Make the Half Square Triangles (HSTs)

1. On the wrong side of a white 2" square [3" square] use a pencil to lightly draw a diagonal line from corner to corner. Layer the marked white 2" square [3" square] atop a solid red 2" square [3" square] with right sides together.



2. Stitch the pair together a scant ¼" from either side of the drawn line. Press to set seams.

3. Cut the unit in half on the drawn line to make 2 half square triangle units ("HSTs").

4. Press the seam allowances toward the red and trim the HSTs to measure 1½" x 1½" [2½" x 2½"] unfinished.

5. Repeat steps 1-4 with 4 additional white 2" squares [3" squares] and 4 additional red solid 2" squares [3" squares] to make 9 HSTs total (you'll end up with one extra).

Make the Candy Striped Center

1. Lay out 9 HSTs in 3 rows of 3 HSTs each as shown.



2. Join the pieces in each row. Press the seam allowances in the top and bottom rows toward the right. Press the seam allowances in the center row toward the left.

3. Join the rows together, pressing seam allowances open, to make a candy striped center measuring 3½" x 3½" [6½" x 6½"] unfinished.

Make the Flying Geese units (star points)

1. On the wrong side of 8 red print 2" squares [3½" squares] use a pencil to lightly draw a diagonal line from corner to corner.

12/16/2018

Original Recipe can be found at www.modabakeshop.com

Recipes are sometimes altered to correct errors. Please ensure that you have downloaded the most recent Printer Friendly Version before starting your project. If you find a mistake in this pattern, please contact modabakeshop@unitednotions.com.

This is an original pattern not intended for sale.

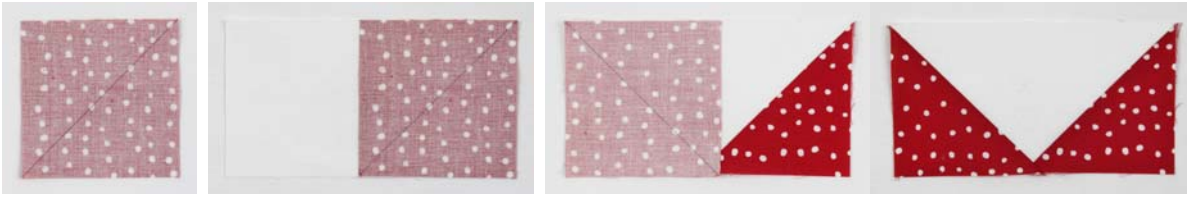

2. Layer a marked red print 2" square [3½" square] atop one end of a white 2" x 3½" rectangle [3½" x 6½" rectangle] with right sides together. Stitch the pair together along the drawn line. Press toward the red and trim seam allowance to ¼".
3. Layer a marked red print 2" square [3½" square] atop the opposite end of the same white 2" x 3½" rectangle [3½" x 6½" rectangle] with right sides together as shown. Stitch along the drawn line. Press toward the red and trim seam allowance to ¼" to make a Flying Geese unit.
4. Repeat to make 4 Flying Geese units measuring 2" x 3½" [3½" x 6½"] unfinished.

Assembling the block

1. Sew a white 2" square [3½" square] to opposite ends of 2 Flying Geese units to make 2 star point rows. Press seam allowances **away** from the white squares.



2. Sew a Flying Geese unit to the left and right sides of the candy striped center. Press seam allowances toward the Flying Geese units.
3. Sew a star point row to the top and bottom of the unit from step 2.
4. Press seam allowances toward the star point rows to complete your block.



This block finishes at 6" or 12" square.



Thank you so much for following along today and I hope you have fun making this block! If you post your finished block on Instagram, please tag me @jendalyquilts—I'd love to see what you make!

Jen Daly

{blog: JenDalyQuilts.com}

{instagram: [/jendalyquilts](https://www.instagram.com/jendalyquilts)}

{shop: [Etsy.com/shop/JenDalyQuilts](https://www.etsy.com/shop/JenDalyQuilts)}

{facebook: [/jendalyquilts](https://www.facebook.com/jendalyquilts)}

12/16/2018

Original Recipe can be found at www.modabakeshop.com

Recipes are sometimes altered to correct errors. Please ensure that you have downloaded the most recent Printer Friendly Version before starting your project. If you find a mistake in this pattern, please contact modabakeshop@unitednotions.com.

This is an original pattern not intended for sale.



INGREDIENTS

6" Block

From white fabric, cut (4) 3" squares, (2) 1-5/8" x 22" strips
From red print #1, cut (2) 3" squares, (2) 1-5/8" x 22" strips
From red print #2, cut (2) 3" squares

12" Block

From white fabric, cut (4) 5" squares, (3) 2-3/4" x 22" strips
From red print #1, cut (2) 5" squares, (3) 2-3/4" x 22" strips
From red print #2, cut (2) 5" squares

INSTRUCTIONS

Sizes for the 6-1/2 inch block are in parenthesis.

For the HST Units:

Place the red and white 5-inch (3-inch) squares right sides together (RST).

Draw a diagonal line on each block.

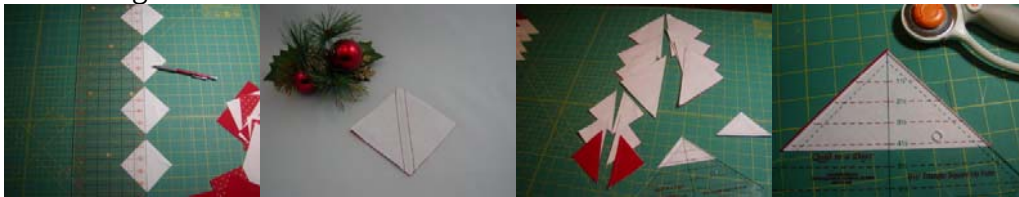

Sew a SCANT 1/4 inch on either side of the diagonal line.

Cut the squares apart on the diagonal line to make two HST units from each square set.

Trim to 4-1/2 inches (2-1/2 inches), and trim off dog ears.

Press open to the dark side for two units, to the light side for 2 units. This will allow the seams to nest.

Assemble the four blocks as shown to make two units, 4 HST's each. Set aside



For the strips:

Place a red and a white strip RST and sew along the 22 inch side to make a strip set

Press open to the dark side to make three (two) strip sets 22 inches long by 5 inches (2-3/4 inches) high.



Cutting the 45 degree triangles:

IMPORTANT: for the 12-1/2 inch block, two strip sets will be cut with red on the top, one with white on the top. For the 6-1/2 inch block both strips can be the same way.

12/16/2018

Original Recipe can be found at www.modabakeshop.com

Recipes are sometimes altered to correct errors. Please ensure that you have downloaded the most recent Printer Friendly Version before starting your project. If you find a mistake in this pattern, please contact modabakeshop@unitednotions.com.

This is an original pattern not intended for sale.



If you are using the 12-1/2 inch square (6-1/2 inch square) ruler it is simply a matter of aligning the center diagonal line on the ruler with the top then bottom of the strip set and aligning the point of the last cut with the point on the ruler. You should have three (four) triangles from each strip set.

NOTE: If you are not using one of these square rulers no worries! You simply need a ruler with a 45 degree line. Scroll down to the bottom to see how to cut the triangle units using a standard 6 by 24 inch ruler.

Gather the triangles in groups of four.

Add these triangles to the HST units, top and bottom first. Trim off those dog ears. Add remaining two units to the sides.



Square up to 12-1/2 (6-1/2) inches.

Cutting 45° triangles with a standard ruler:

Mark the 45 degree line on your ruler. As above, place this line on the bottom of your strip set.



Make the cut and then flip the ruler over, right to left so you are looking at the back of the ruler.

With this method you always line up the 45 degree line with the BOTTOM of the strip set.

Again, make the cut and then flip the ruler back, left to right so you are looking at the correct side of the ruler, lining up the 45 degree line with the BOTTOM of the strip set.

Continue this process to the end of the strip set. A bit more work than the 12-1/2 (6-1/2) inch square ruler but the end result is the same!



This block finishes at 6" or 12" square.

Barbara Esposito

{instagram: [@theQuiltedB](https://www.instagram.com/theQuiltedB)}

12/16/2018

Original Recipe can be found at www.modabakeshop.com

Recipes are sometimes altered to correct errors. Please ensure that you have downloaded the most recent Printer Friendly Version before starting your project. If you find a mistake in this pattern, please contact modabakeshop@unitednotions.com.

This is an original pattern not intended for sale.



INGREDIENTS

6" Block

From white fabric, cut: (2) 3" squares, (2) 2 1/2" squares, (2) 1 3/4" x 10" strip
From red print #1, cut: (2) 3" squares, (2) 2 1/2" squares, (2) 1 3/4" x 10" strip

12" Block

From white fabric, cut: (2) 5" squares, (2) 3" squares, (2) 1 1/2" x 22" strips
From red print #1, cut: (2) 5" squares, (2) 3" squares, (2) 1 1/2" x 22" strips

INSTRUCTIONS

Make Half Square Triangle Units (HSTs), (6" Block in parentheses)

1. The center pinwheel and the corner units are **HSTs**. For the center pinwheel place the 5"(3") red and white squares right sides together. For the corner units do the same with the 3"(2 1/2") red and white squares
2. Draw a diagonal line on the white square. Stitch with a 1/4" seam on both sides of the drawn line. Cut on the line. Press the seam to the red.
3. Square up the pinwheel HST units to 4 1/2" x 4 1/2"(2 1/4" x 2 1/4")
4. Square up the corner HST units to 2 1/2" x 2 1/2" (1 3/4" x 1 3/4")

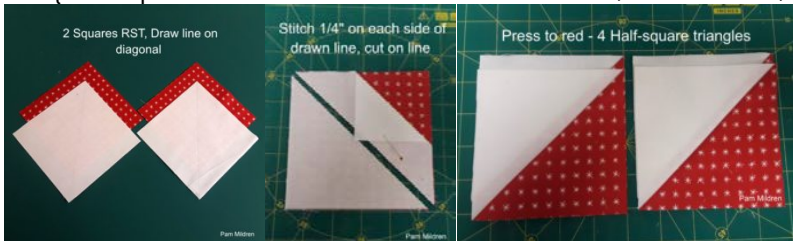

Make the Pinwheel Block

1. Lay out your 4 blocks with the red corners pointing in the right direction to give the pinwheel design. Join 2 block together, press seams in opposite directions. Pin the block pairs, nesting the center seams and stitch. This seam can be pressed open to reduce bulk or in either direction.
2. Trim the center pinwheel block if needed to 8 1/2" x 8 1/2" (4" x 4")

Make Strip Sets For Borders

1. Using the 1 1/2" x 22" strips (1 3/4" x 10"), stitch together in pairs red/white, press to the red, join the pairs together and press the final seam to the red.
2. Sub-cut the 1 1/2" strip set into (8) 2 1/2". For the 6" block sub-cut (4) 1 3/4".
3. For the 12" block join (2) 2 1/2" units, press to the red to form 4 border units.
4. For the 6" block use only one of the sub-cuts (1 3/4" x 4") per border. If your strip set unit is a bit larger than 4", take a little bit larger seam between the units.

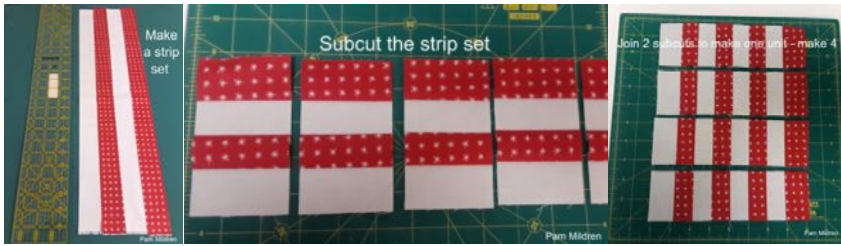

Final Block Piecing

1. Lay out the units for your block. Place the border units in the same orientation to form an alternating color scheme around the center.
2. Join the corner HST units to the pieced border. Press toward the border.
3. Join a border unit to the left and right side of the pinwheel center block. Press seam toward the pinwheel block.
4. Pin the top and bottom units to the center pinwheel, stitch, and press toward the center.

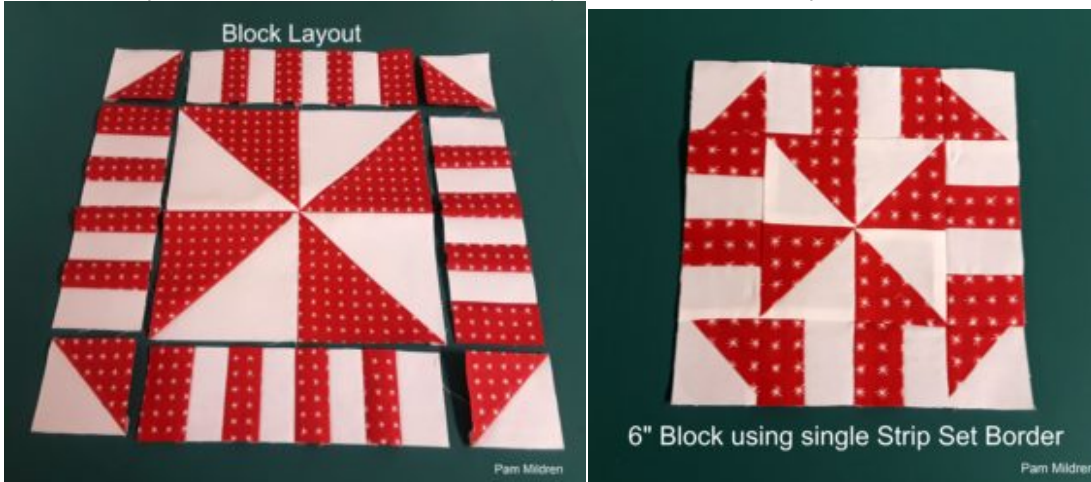

This block finishes at 6" or 12" square.
Blessings for a joyous Christmas!

Pam Mildren

{instagram: [@PamMildren](#)}

{shop: [Longarm Quilting by Pam](#)}

{facebook: [Longarm Quilting by Pam](#)}



INGREDIENTS

6" Block

From white fabric, cut (5) 2 3/8" squares
 From solid red fabric, cut (5) 2 3/8" squares, (2) 2" squares
 From red print, cut: (1) 3 1/2" square

12" Block

From white fabric, cut (5) 3 7/8" squares
 From solid red fabric, cut (5) 3 7/8" squares, (2) 3 1/2" squares
 From red print, cut: (1) 6 1/2" square

INSTRUCTIONS

NOTE: The instructions below are for the 12" finished block, with changes for the 6" finished block in parentheses.

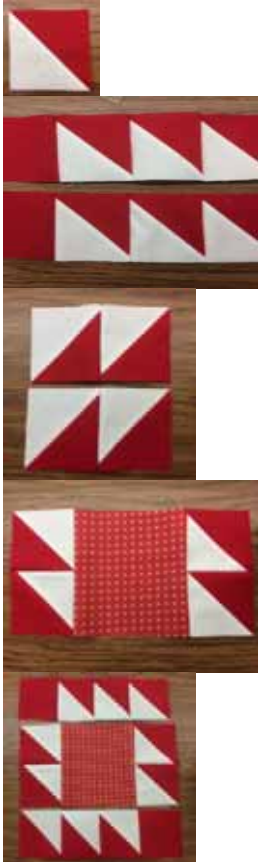

Step 1: Cut each of the 3 7/8" (2 3/8") red solid squares and white solid squares on the diagonal. Sew into ten half square triangles (HSTs).

Step 2: Sew two sets of three HSTs so they look like the photo. Be sure the solid red is on the upper right and the solid white is on the lower left.

Add a 3 1/2" (2") solid red square to the left end of each set.

Step 3: Sew the remaining HSTs into two pairs so they look like the photo. Be sure the solid red is on the lower right and the solid white is on the upper left.

Step 4: Sew the HST pairs to the sides of your 6 1/2" (3 1/2") center square. Be sure the white edge is against the center square.

Step 5: Sew the HST strips to the top and bottom of the center square unit. Be sure the solid red square is on the left end of the top row and the right end of the bottom row.

YIELD

This block finishes at 6" or 12" square.

Have a Merry Christmas!

Anne Wiens

[blog: Seams Like a Plan](#)

[facebook: SweetgrassCreativeDesigns](#)



INGREDIENTS

6" Block

From white fabric, cut: (1) 3½" x 3½" square, (2) 3" x 3" squares, (4) 1¼" x 2" rectangles, (4) 1¼" x 1¼" squares

From solid red fabric, cut: (4) 2½" x 2½" squares*

From red print, cut: (2) 3" x 3" squares, (4) 2" x 2" squares, (4) 1¼" x 1¼" squares

12" Block

From white fabric, cut: (1) 6½" x 6½" square, (2) 4¾" x 4¾" squares, (4) 2" x 3½" rectangles, (4) 2" x 2" squares

From solid red fabric, cut: (2) 4¾" x 4¾" squares, (4) 3½" x 3½" squares, (4) 2" x 2" squares

From red print, cut: (4) 4" x 4" squares*

Note that the placement of the solid red fabric and the red print were reversed in the two pictured blocks. The star point pieces are marked with an *.

INSTRUCTIONS

The following instructions are for the 12" block. The 6" block is made exactly the same way, but the 6" block patch sizes are listed in the brackets [].

Make Split Quarter Square Triangles (Split QSTs)

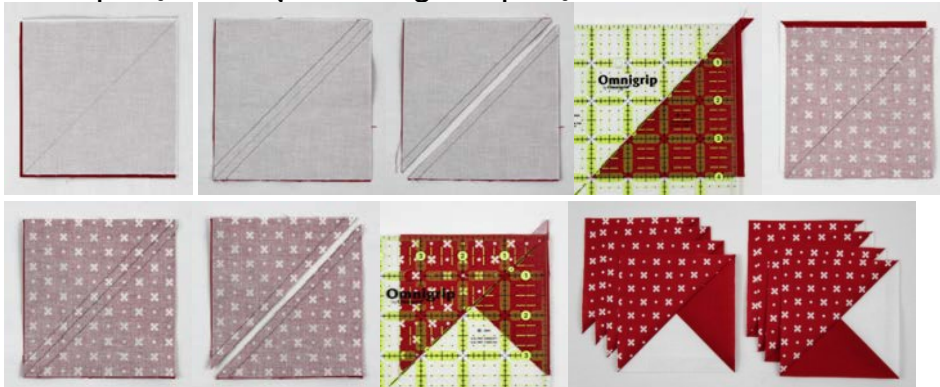

1. On the wrong side of a white 4¾" square [3" square] use a pencil to lightly draw a diagonal line from corner to corner. Layer the marked white 4¾" square [3" square] atop a solid red 4¾" square [3" square] with right sides together.
2. Stitch the pair together a scant ¼" from either side of the drawn line. Press to set seams.
3. Cut the unit in half on the drawn line to make 2 half square triangle units ("HSTs").
4. Press the seam allowances toward the red and trim the HST units to measure 4" x 4" [2½" x 2½"] unfinished.
5. On the wrong side of 2 red print 4" squares [2½" squares] use a pencil to lightly draw a diagonal line from corner to corner. Layer the 2 marked red print 4" squares [2½" squares] atop the white/red HST units with right sides together. Make sure that the lines drawn on the red print squares are perpendicular to the seam between the white and red triangles on the HSTs.
6. Stitch the pairs together a scant ¼" from either side of the drawn line. Press to set seams.
7. Cut the units in half on the drawn line to make 4 split quarter square triangle units.
8. Press seam allowances toward the red print and trim the 4 split QSTs to 3½" x 3½" [2" x 2"] unfinished. Note that you'll end up with 2 split QSTs that are the mirror of the other 2.
9. Repeat with remaining white and red solid 4¾" squares [3" squares] and red print 4" squares [2½" squares] to make 8 split QSTs—4 with the white in one quarter and 4 with the white in an adjacent, or mirror, quarter.

Make Block Corners

1. Lay out a white 2" x 3½" rectangle [1¼" x 2" rectangle], a white 2" square [1¼" square], and a red solid 2" square [1¼" square] in 2 rows as shown.

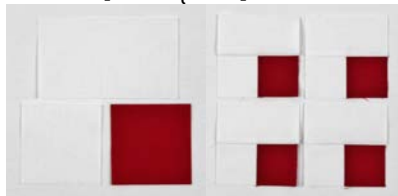

2. Join the white and red 2" squares [1¼" squares]. Press seam allowances toward the red. Sew the white 2" x 3½" rectangle [1¼" x 2" rectangle] to the top of the white/red square unit. Press seam allowances toward the white rectangle to make a corner unit measuring 3½" x 3½" [2" x 2"] unfinished. Repeat to make 4 corner units.

Make Square-in-a-Square Center

1. On the wrong side of a red solid 3½" square [2" square] use a pencil to lightly draw a diagonal line from corner to corner. Layer the marked red 3½" square [2" square] atop one corner of the white 6½" square [3½" square] with right sides together. Stitch the pair together exactly on the drawn line.



2. Trim the seam allowance to ¼" and press toward the white. If you're worried about the edge of the red fabric showing through the white, grade the seams (trim the red seam allowance closer to the seam).
3. Repeat steps 1 and 2 with the remaining corners of the white 6½" square [3½" square] to make a Square-in-a-Square center measuring 6½" x 6½" [3½" x 3½"] unfinished.

Assemble Block

1. Join together 1 split QST and 1 mirror split QST as shown to make a split QST pair. Press seam allowances open. Repeat to make 4 split QST pairs.



2. Sew a corner unit to opposite ends of 2 split QST pairs as shown to make 2 split QST rows. Press seam allowances toward the corner units.
3. Sew the remaining split QST pairs to the left and right sides of the Square-in-a-Square center. Press seam allowances toward the center.
4. Sew a split QST row to the top and bottom of the unit from step 3. Press seam allowances toward the center.



This block finishes at 6" or 12" square.



Jen Daly
{blog: JenDalyQuilts.com}
{instagram: [/jendalyquilts](https://www.instagram.com/jendalyquilts)}
{shop: [Etsy.com/shop/JenDalyQuilts](https://www.etsy.com/shop/JenDalyQuilts)}
{facebook: [/jendalyquilts](https://www.facebook.com/jendalyquilts)}

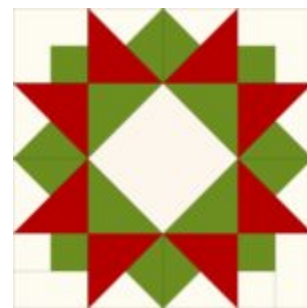

12/20/2018

Original Recipe can be found at www.modabakeshop.com

Recipes are sometimes altered to correct errors. Please ensure that you have downloaded the most recent Printer Friendly Version before starting your project. If you find a mistake in this pattern, please contact modabakeshop@unitednotions.com.

This is an original pattern not intended for sale.



INGREDIENTS

6" Block

From white fabric, cut (4) 1½" squares, (8) 1½" x 1" rectangles, (4) 2½" x 2" rectangles, (1) 2½" square, (8) 1" squares

(4) 1 1/2" squares, (8) 1 1/2" x 1" rectangles, (4) 2" x 2 1/2" rectangles, (1) 2 1/2" square, (8) 1" squares

From red fabric, cut (8) 1½" x 1" rectangles, (4) 2½" x 1" rectangles, (8) 1" squares

12" Block

From white fabric, cut (4) 2½" squares, (8) 2½" x 1½" rectangles, (4) 4½" x 3½" rectangles, (1) 4½" square, (8) 1½" squares

From red fabric, cut (8) 2½" x 1 1/2" rectangles, (4) 4½" x 1½" rectangles, (8) 1½" squares

INSTRUCTIONS

Dimensions for 12" block are shown in brackets [].

Make Modified 9-Patches

- 1 - Make 4-patches by sewing (2) 1" [1½"] red squares to (2) 1" [1½"] white squares.
- 2 - Sew (1) 1½" x 1" [2½" x 1½"] red rectangle to (1) 1½" x 1" [2½" x 1½"] white rectangle. Repeat to make two of these units.
- 3 - Join (1) unit from Step 2 with (1) 1½" square [2½"] white square.
- 4 - Join (1) unit from Step 2 with a 4-patch unit.
- 5 - Assemble modified 9-patch block as shown. Repeat to make 4 modified 9-patch blocks.

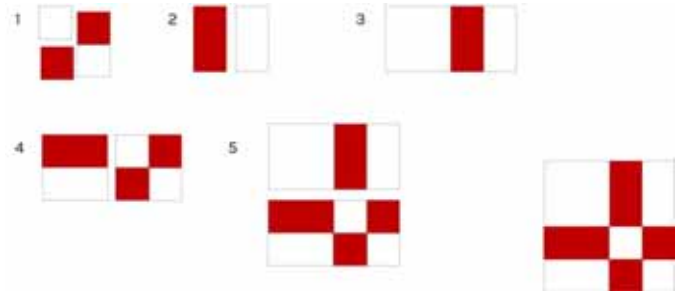

Make Modified 2-Patches

Combine (1) 2½" x 2" [4½" x 3½"] white rectangles with (1) 2½" x 1" [4½" x 1½] red rectangle to create modified 2-patches. Repeat to make 4 modified 2-patches.



Assemble Block

The entire block goes together in rows just like a 9-patches. Starch and press. That's it!

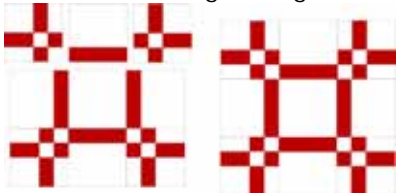

YIELD

This block finishes at 6" or 12" square.

I hope your holiday preparations are going well! Enjoy this weekend and have a wonderful Christmas!

12/22/2018

Original Recipe can be found at www.modabakeshop.com

Recipes are sometimes altered to correct errors. Please ensure that you have downloaded the most recent Printer Friendly Version before starting your project. If you find a mistake in this pattern, please contact modabakeshop@unitednotions.com.

This is an original pattern not intended for sale.

Lisa Calle
{instagram: [@vintagemodernquilts](https://www.instagram.com/vintagemodernquilts)}

12/22/2018

Original Recipe can be found at www.modabakeshop.com

Recipes are sometimes altered to correct errors. Please ensure that you have downloaded the most recent Printer Friendly Version before starting your project. If you find a mistake in this pattern, please contact modabakeshop@unitednotions.com.

This is an original pattern not intended for sale.



INGREDIENTS

6" Block

From white fabric,
cut (4) 1 3/8" x 5 1/8" strips (C),
(1) 1" x 1" square (E)
From solid red fabric, cut (4) 1" x 3 1/4" strips (B)
From red print #1, cut: (2) 3 5/8" squares (A)
From red print #2, cut (2) 2 3/8" squares (D)

12" Block

From white fabric,
cut (4) 2 1/4" x 9" strips (F),
(1) 1 1/2" x 1 1/2" square (G)
From solid red fabric, cut (4) 1 1/2" x 6" strips (H)
From red print #1, cut: (2) 6 3/8" squares (I)
From red print #2, cut (2) 3 7/8" squares (J)

INSTRUCTIONS

The 6" and 12" blocks are made in the same way. Information for the 12" block is shown in parentheses.

NOTE: Red Dot...Green Dash and The North Pole? fabrics were used in the 12" block.

1. Cut both red print #2 D (J) squares once diagonally.

HINT: If you are using directional fabric, cut one square from top left to bottom right and the other from top right to bottom left. Your design will sit correctly in the block.

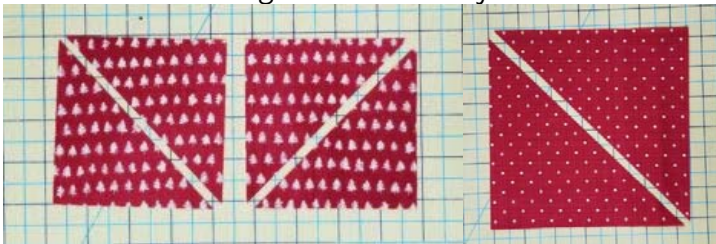

2. Cut both red print #1 A (I) squares once diagonally.

3. Trim both ends of all white fabric C (F) strips at a 45° angle.

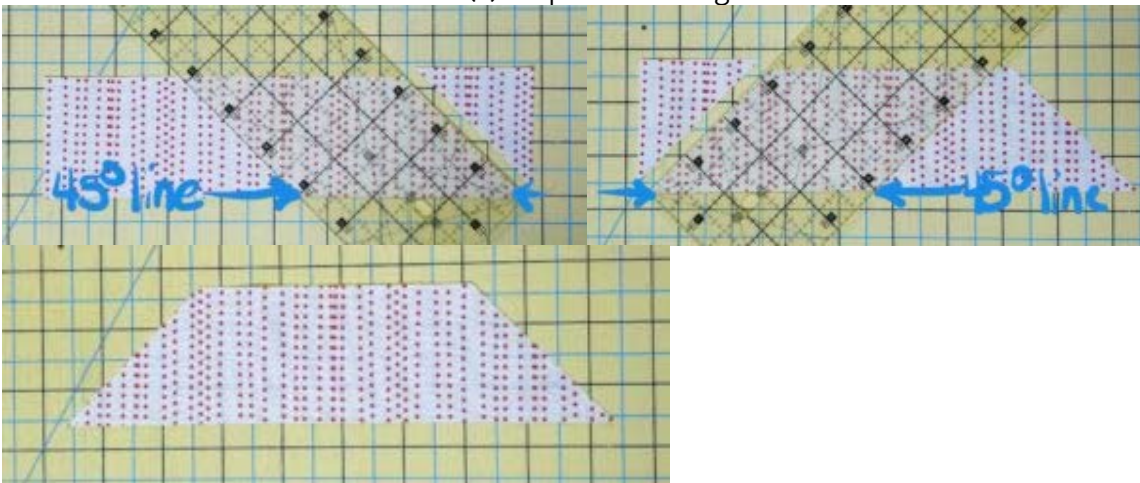

4. Lay out and stitch together a red print #1 triangle, a white fabric C (F), and a red print #2 triangle. Make 4 pieced squares. HINT: Marking and matching the center of adjoining pieces makes assembly easier. Make four pieced squares.



5. Paying attention to block orientation, stitch a pieced square to opposite sides of red solid B (H). Make two rows.
6. Stitch a red solid B (H) to opposites sides of a white E (G).

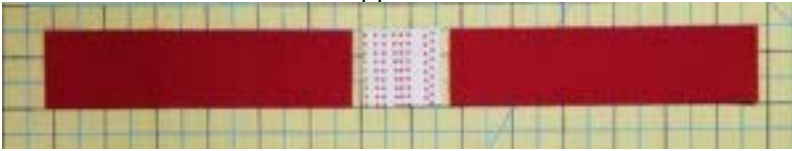

7. Layout out the rows, match seams, and stitch together completing your Tinsel Tangle block.



This block finishes at 6" or 12" square.

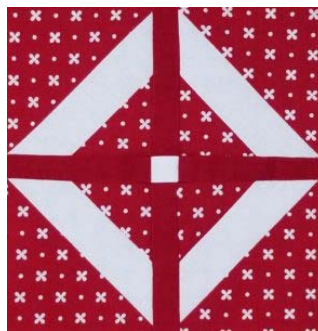

Thank you for following along with my Tinsel Tangle block. If you make one, please share your version and tag me on Instagram (@dennielebohannon). I always love to see what you create. Most days, I am posting about quilting on Facebook at Louanna Mary Quilt Design. Come visit me. Wishing you and your family a Merry Christmas.

Denniele Bohannon
{instagram: [@dennielebohannon](#)}
{shop: [Louanna Mary Quilt Design](#)}
{facebook: [louannamaryquilttdesign](#)}

12/4/2018

Original Recipe can be found at www.modabakeshop.com

Recipes are sometimes altered to correct errors. Please ensure that you have downloaded the most recent Printer Friendly Version before starting your project. If you find a mistake in this pattern, please contact modabakeshop@unitednotions.com.

This is an original pattern not intended for sale.



INGREDIENTS

6" Block

From background fabric, cut (1) $3\frac{1}{2}$ " square, (4) $2\frac{3}{8}$ " squares cut once on the diagonal to create 8 triangles, and (4) 2" squares
From red print #1, cut (2) $2\frac{3}{4}$ " squares cut twice on the diagonal to yield 8 triangles

From red print #2, cut (2) $2\frac{3}{4}$ " squares squares cut twice on the diagonal to yield 8 triangles

12" Block

From background fabric, cut (1) $6\frac{1}{2}$ " square, (4) $3\frac{3}{8}$ " squares cut once on the diagonal to create 8 triangles, and (4) $3\frac{1}{2}$ " squares
From red print #1, cut (2) $4\frac{1}{4}$ " squares cut twice on the diagonal to yield 8 triangles

From red print #2, cut (2) $4\frac{1}{4}$ " squares squares cut twice on the diagonal to yield 8 triangles

INSTRUCTIONS

Make Quarter Square Triangles

Pair each red print #1 triangle with a red print #2 triangle. Sew together using a scant $\frac{1}{4}$ " seam. Press seam open (this will reduce bulk). Join with a background triangle as shown. Press toward the darker fabric. Square up to 2" [$3\frac{1}{2}$ " square. Make 8 of these units.



Assemble Block

Assemble block in rows as shown. Starch and press completed block. Trim to $6\frac{1}{2}$ " [$12\frac{1}{2}$ "] square.

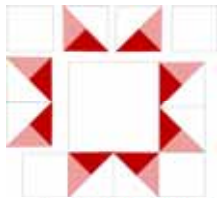

YIELD

This block finishes at 6" or 12" square.

Have a wonderful Christmas Eve!

Oda May

{instagram: [@ModaBakeShop](#)}

{facebook: [Moda Bake Shop](#)}

{facebook group: [Moda Bake Shop Bakers](#)}



INGREDIENTS

6" Block

From white fabric, cut (2) 3 ½" squares and (4) 2 ½" squares
From red fabric, cut (2) 3 ½" squares and (1) 2 ½" squares

12" Block

From white fabric, cut (2) 5 ½" squares and (4) 4 ½" squares
From red fabric, cut (2) 5 ½" squares and (1) 4 ½" squares

INSTRUCTIONS

We'll start by making the four hour glass blocks. I'll be sharing the instructions for the 12" block with any dimensions for the 6" block in parentheses.

Gather the two white 5 ½" (3 ½") squares and the two red 5 ½" (3 ½") squares. Referring to the image below, follow the steps 1-4 to make four half-square triangles.

1. Draw a line corner-to-corner on the wrong side of the two white 5 ½" (3 ½") squares.
2. Pair a white square right sides together with a red 5 ½" (3 ½") square. Sew two seams, each 1/4" away from the drawn line.
3. Cut the pieces apart on the drawn line.
4. Press the seams open.

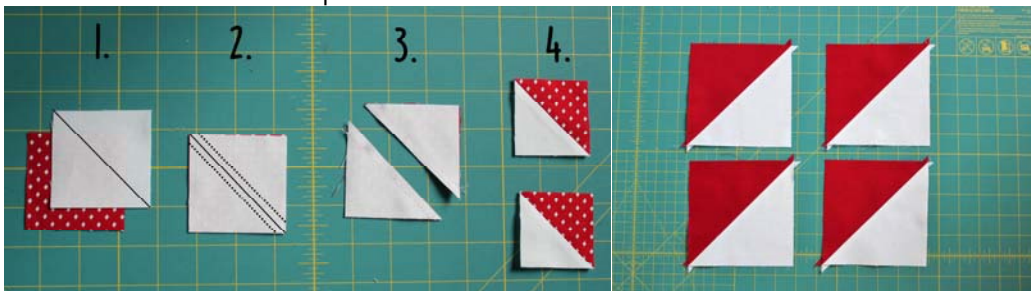

Repeat with the second red and white square combination to make a total of four half-square triangles.

Draw a line from corner-to-corner on the wrong side of two of the half-square triangles (HSTs). The line should run perpendicular to the seam as shown in the photo below. Place the HSTs with the lines drawn, right sides together on top of the other two HSTs, so the seams are right on top of each other, as shown.



Make sure the seams are lined up as close as possible. It's okay if the outer edges of the HSTs aren't quite matched up--the important part is that those seams are right on top of each other.

Sew two lines, each 1/4" away from the drawn line, then cut the pieces apart on the drawn line. Press the seam open to yield two hourglass blocks. Repeat with second pair of HSTs to yield a total of four hourglass blocks.

The hourglass units were made slightly oversized so we can trim them down to the exact size we need. For the 12" Night Divine block, we will trim the hourglass units down to 4 1/2" squares and for the 6" Night Divine Block, the hourglass units will need to be trimmed to 2 1/2" squares.

You'll want the center point of the hourglass blocks where the seams meet to be as close as possible to the center of the trimmed block. The easiest way to do this is to get a square ruler and line up the center point of the hourglass unit at 2 1/4" (1 1/4") on the diagonal. Then trim the top and right sides of the hourglass unit. Turn the hourglass unit 180 degrees so the last two untrimmed edges are now at the top and right sides. Line up the center point as close to 2 1/4" (1 1/4") as possible while trimming the hourglass unit to 4 1/2" x 4 1/2" square (2 1/2" x 2 1/2" square). The center seam might be slightly off on that last positioning, but it's okay! We did our best to get it centered. :)



Trim the remaining hourglass units to yield four 4 1/2" x 4 1/2" square (2 1/2" x 2 1/2" square) hourglass units.

Lay out the hourglass units with the 4 1/2" (2 1/2") white and red squares as shown below.

Assemble each row, pressing the seams away from the hourglass units. Sew the rows together and press the seams open.

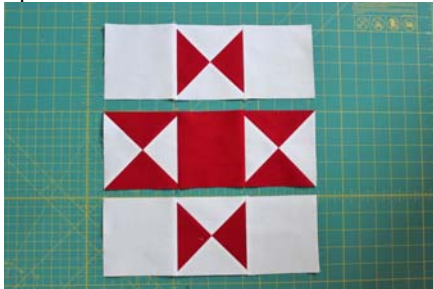

 **YIELD**

This block finishes at 6" or 12" square.

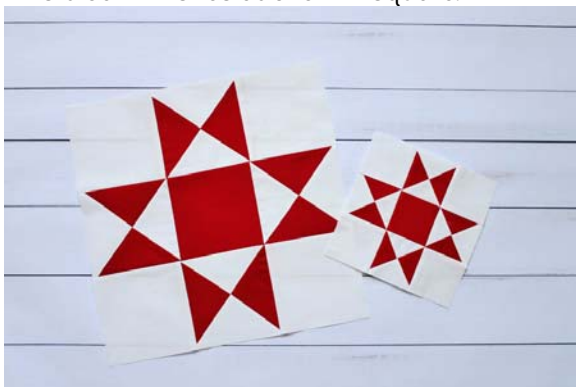

Aren't the blocks striking in a simple red and white color combination? I've loved following along with all of your Countdown to Christmas blocks and would love to see your Night Divine blocks, too. Please use the hashtag #centerstreetquilts on instagram so I can find your blocks! Wishing you a happy holiday and a new year filled with lots of sewing time. :)

Kristina Brinkerhoff

{blog: [Center Street Quilts](#)}

{instagram: [@centerstreetquilts](#)}

{shop: [Center Street Quilts on Etsy](#)}

12/16/2018

Original Recipe can be found at www.modabakeshop.com

Recipes are sometimes altered to correct errors. Please ensure that you have downloaded the most recent Printer Friendly Version before starting your project. If you find a mistake in this pattern, please contact modabakeshop@unitednotions.com.

This is an original pattern not intended for sale.



INGREDIENTS

- (4) 12" Countdown to Christmas blocks
- (16) 6" Countdown to Christmas blocks
- 2 1/4 yards white fabric
- 1/2 yard red for binding
- 3 7/8 yards backing

INSTRUCTIONS

From white fabric, cut (5) 12 1/2" x width-of-fabric (WOF) strips. Sub-cut into thirteen 12 1/2" squares. Cut (2) 6 1/2" x WOF strips. Sub-cut into sixteen 6 1/2" squares. Use the leftover piece from the 12 1/2" strip to cut the remaining blocks. From the red fabric, cut (6) 2 1/2" x WOF binding strips.

NOTE: The red squares represent the Countdown to Christmas blocks that are already pieced.

Stitch a white 6 1/2" square and a 6" Countdown to Christmas block together. Stitch two rows together creating a four-patch block. Make eight four-patch blocks.

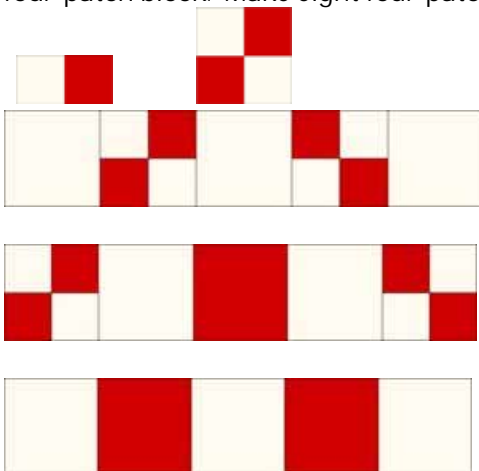

{Make 8}

{Make 2}

{Make 2}

{Make 1}

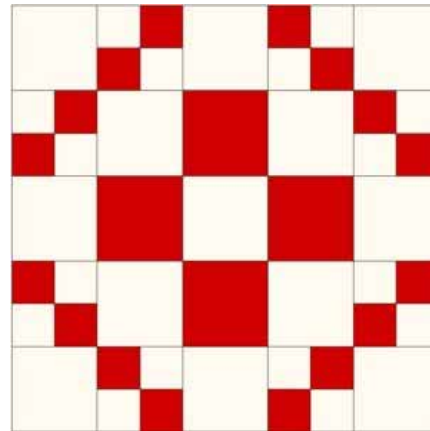

Layout the five rows, match seams, and stitch together to complete the Boxing Day top.

Layer the quilt top, batting, backing, and quilt as desired.

Stitch the binding strips together using diagonal seams, fold in half with wrong sides together, and press.

Stitch the binding to the quilt front. Fold over and hand stitch to the back.

YIELD

The Boxing Day quilt finishes at 60" x 60".

Denniele Bohannon

{instagram: [@dennielebohannon](#)}

{shop: [Louanna Mary Quilt Design](#)}

{facebook: [louannamaryquilt design](#)}

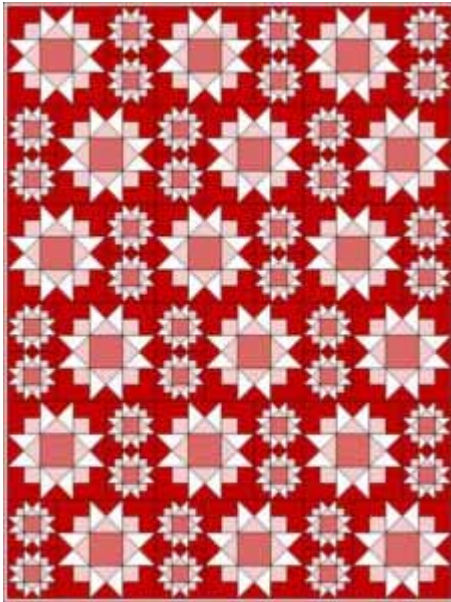

INGREDIENTS

54" x 72" Lap Quilt

(18) 12" blocks, (36) 6" blocks
Backing Size: 63" x 80" (3.5 yards)
Batting Size: 63" x 80"
Binding: 7 2.5" x WOF strips (.5 yd)

72" x 72" Snuggle Quilt

(24) 12" blocks, (48) 6" blocks
Backing Size: 81" x 81" (4.5 yards)
Batting Size: 81" x 81"
Binding: 8 2.5" x WOF strips (.75yds)

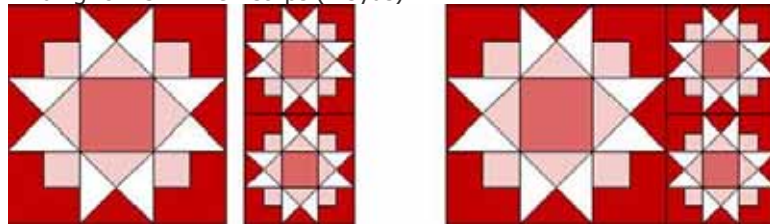

INSTRUCTIONS

First, the basic "Sidestep" setting unit. It is simply one 12.5" (unfinished size) block plus two 6.5" blocks sewn into a pair, then sewn to the larger block. This gives you a 12.5" x 18.5" unit.

Note: My illustrations show only my [Prairie Christmas Star](#) block. You decide which blocks you put in your quilt and how many of each block you want to make.

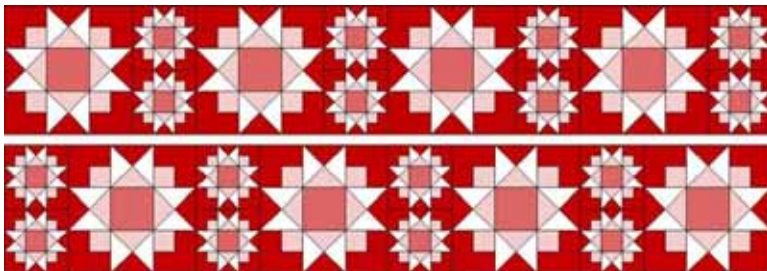

To construct these quilts, sew the units into horizontal rows. Rows 1, 3 and 5 will have the small blocks on the right side of the large blocks. Rows 2, 4, and 6 have the small blocks on the left side of the large blocks.

Option 1 is a 54" x 72" Lap Quilt. For this option, you will need 18 large blocks and 36 small blocks. Again, you get to choose which eighteen large blocks you choose. Personally, I would choose the more complicated patterns for the

the large blocks, and use the simpler patterns for the small blocks. There are six rows in this quilt with three units in each row.

Because so many of you have already made all 25 large blocks, here is **Option 2**, which has four units per row, and six rows, for a 72" x 72" quilt...large enough to share with your favorite snuggle buddy!

The "Snuggle" quilt takes 24 large blocks and 48 small blocks.

If that seems like more small blocks than you want to make, consider substituting some 6.5" 4-Patch and/or 9-Patch blocks, and/or some 6.5" fussy cuts of your favorite Christmas prints or plaids. It's your quilt, so let your creativity shine!

Use the charts below to plot the placement of your sampler blocks.

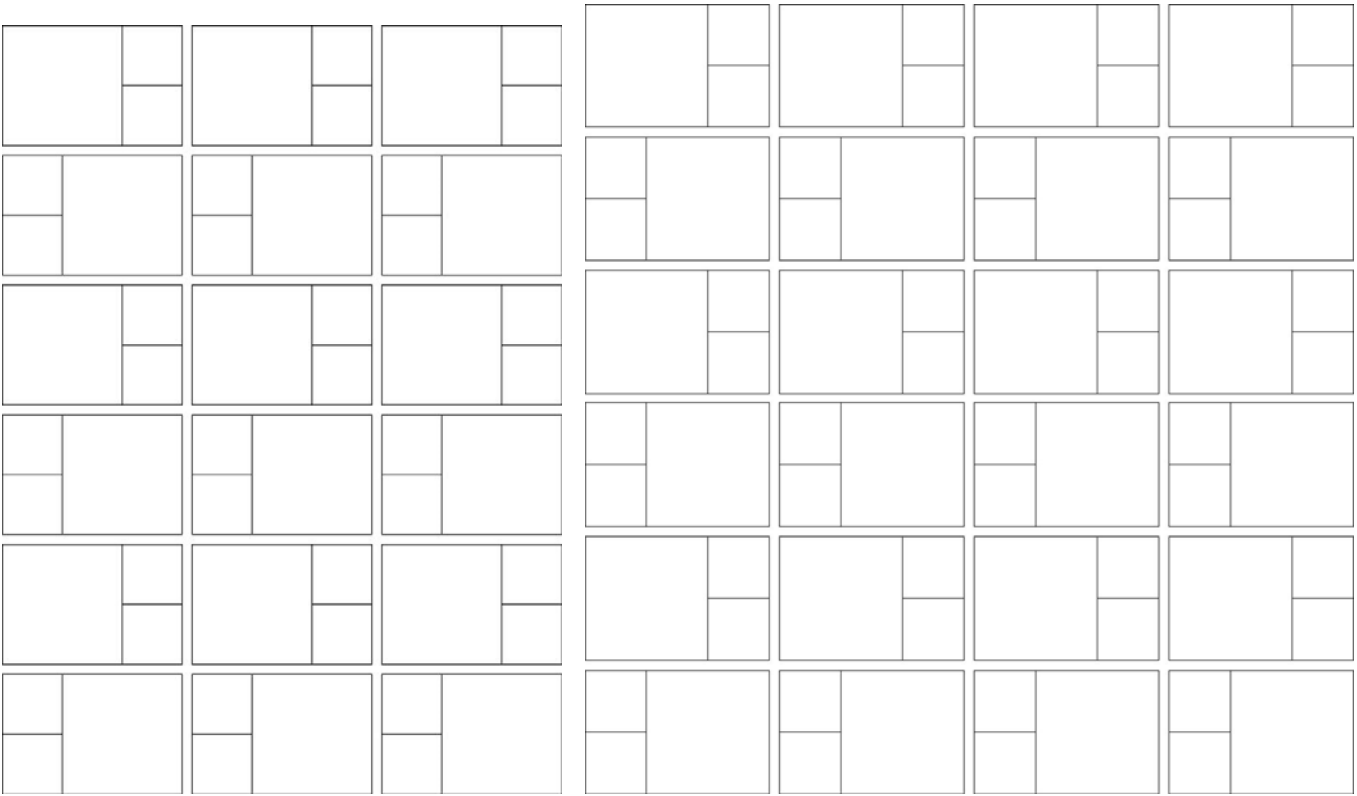

54" x 72" Lap Quilt or 72" x 72" Snuggle Quilt

In just a few days, we get to unwrap a bright shiny new year, and I know the Moda Bake Shop chefs are already hard at work on dozens of new recipes to share with you. I hope to contribute two or three myself. In the meanwhile, I hope you'll follow my blog posts on Wordpress.com, and "Like" my Facebook page (links below).

Happy New Year!

Anne Wiens

{blog: [Seams Like a Plan](#)}

{facebook: [SweetgrassCreativeDesigns](#)}

12/28/2018

Recipes are sometimes altered to correct errors. Please ensure that you have downloaded the most recent Printer Friendly Version before starting your project. If you find a mistake in this pattern, please contact modabakeshop@unitednotions.com.

This is an original pattern not intended for sale.

Original Recipe can be found at www.modabakeshop.com

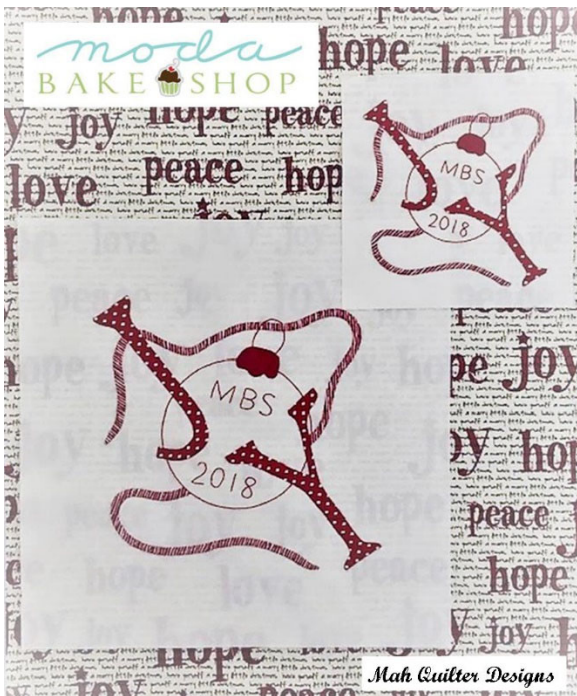

🎄 INGREDIENTS

- Applique pattern at the end of this file
- White background fabric - 7" square for **6" block** - 13" square for **12" block**
- Solid red for Christmas ornament top - 1.5" square for **6" block** - 2" square for **12" block**.
- Red dot for J and Y letters - 5" sq. for **6" block** - 8" sq. for **12" block**.
- Red and white stripe for ribbon - 5" x 7" for **6" block** - 6" x 10" for **12" block**
- Red floss for embroidery, one skein - I used one strand for embroidery.
- Supplies needed for your favorite method of applique.

🎄 INSTRUCTIONS

Prepare your applique pattern pieces using your favorite method. Use placement guide for pattern pieces.

Method of preparation is the same for either size, with the exception of background fabric and pattern piece sizes.

Letters



Top of Christmas ball



Ribbon

12/31/2018

Recipes are sometimes altered to correct errors. Please ensure that you have downloaded the most recent Printer Friendly Version before starting your project. If you find a mistake in this pattern, please contact modabakeshop@unitednotions.com.

This is an original pattern not intended for sale.

Original Recipe can be found at www.modabakeshop.com

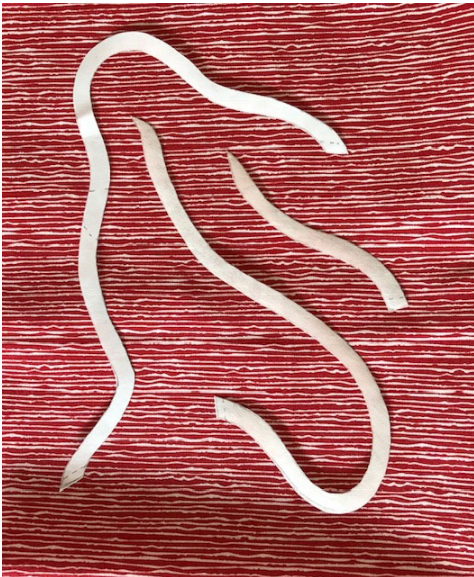

6" block Joy 6 inch block

Use a 7" square of background fabric.

Christmas ball measures 3"

Using your favorite method of applique, use the pattern for making your pattern pieces and as a placement guide.

Use a pencil to trace ball line, hanging line on ribbon, MBS and 2018 or anything you want to add to your label.

When all applique is complete, embroider drawn lines using outline stitch or your favorite embroidery stitch. I used one strand of floss for all embroidery.

When block is completed, iron and re-cut background fabric to 6.5".

12" block

Use a 13" square of background fabric.

Christmas ball measures 4.5"

There are two pattern sheets/placement guides that will need to be taped together to get size needed to fit a 12" square.

Align dash lines on page 1 over dash lines on page 2 making sure pattern pieces line up, Tape together. You will now have one piece to make all pattern pieces and pattern guide.

The preparation and assembly process will be the same as the 6" block.

When all applique and embroidery is completed, re-cut background fabric to 12.5" square.



This block finishes at 6" or 12" square.

I hope my Christmas block brings joy to all who make it. Its been a fabulous year sharing my designs with Moda Back Shop followers. Thank you for allowing me to use my love of hand applique to inspire others in this venue.

Mary Andra Holmes

{blog: [sistersquiltingtrunk](#)}

{Instagram: [@mahquilter](#)}

